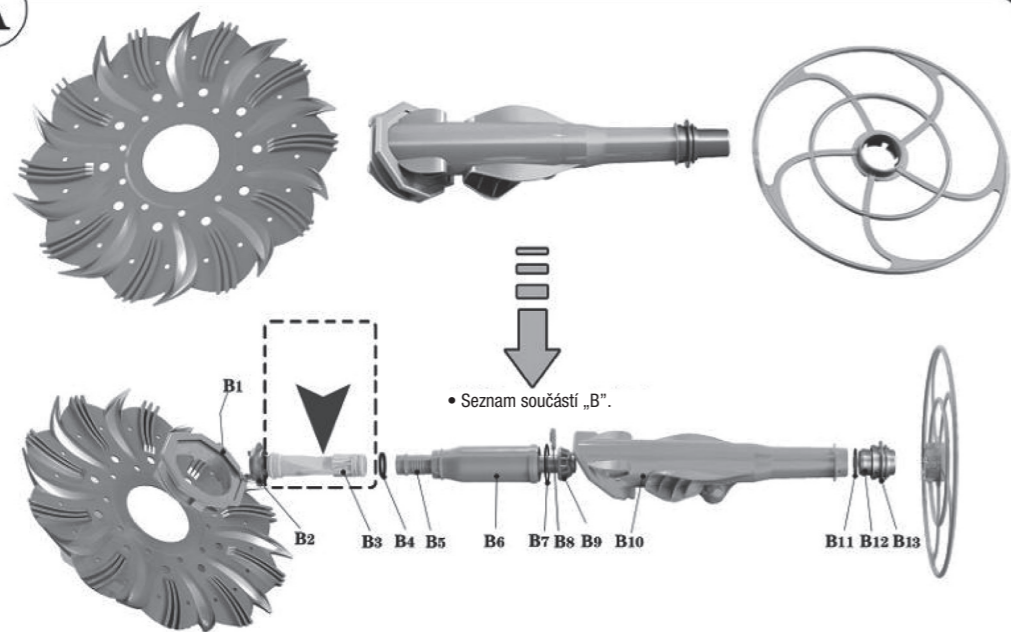
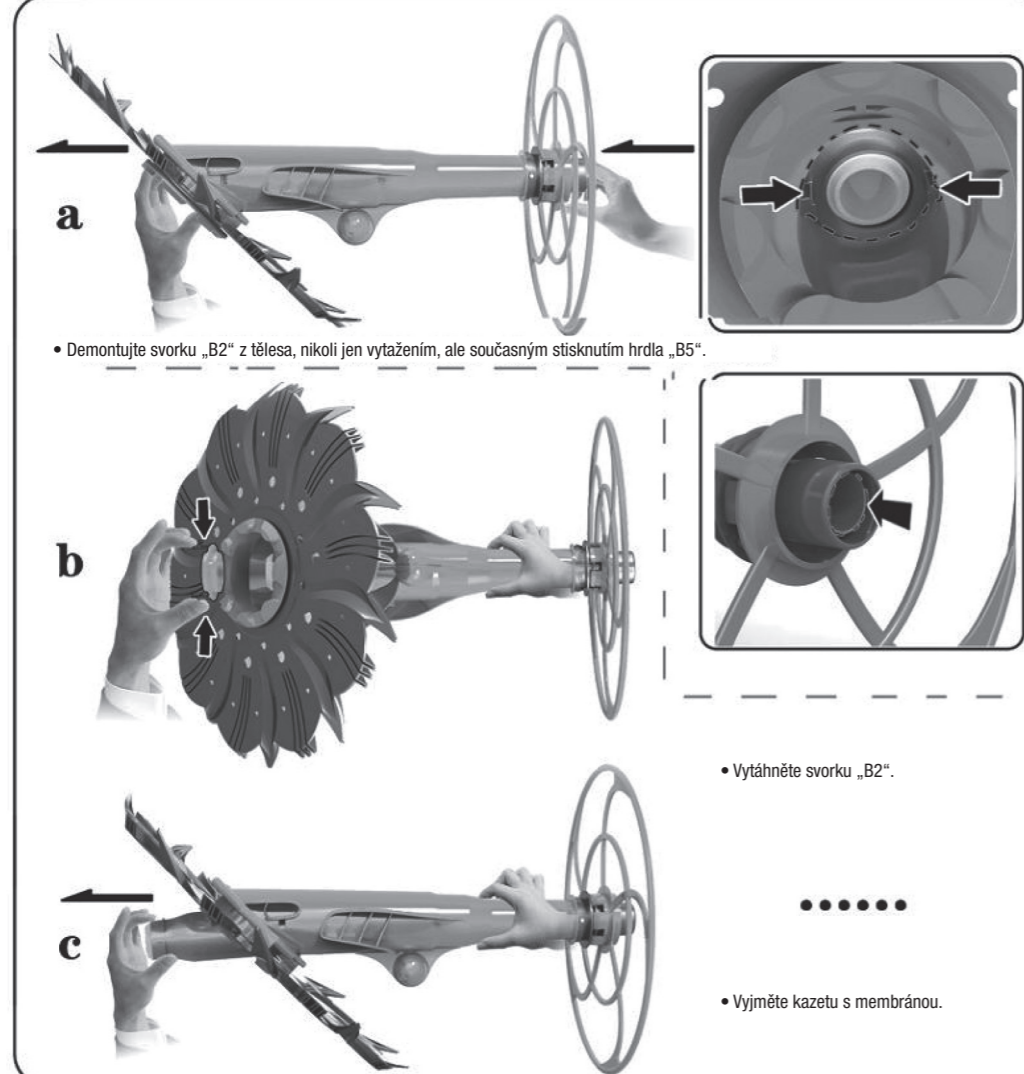
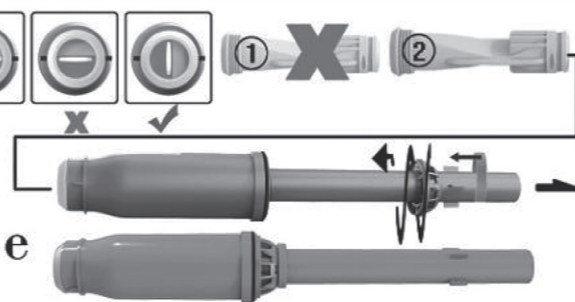
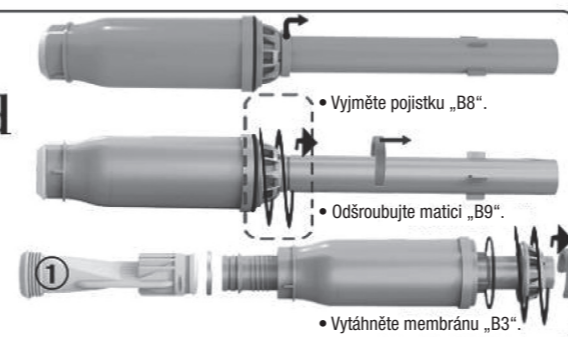

A

Vyměňte membránu následovně:

B**d****POZOR:**

1) Díl „B9“ se NESMÍ příliš utahovat, jinak se membrána otevře doširoka, což má negativní vliv na její výkon.
2) Membrána musí být umístěna na stejném vedení jako těleso „B6“.

• Nainstalujte novou membránu „2“, montáž odpovídá výše uvedenému postupu v opačném pořadí.

• Nainstalujte díly vysavače níže uvedeným způsobem.

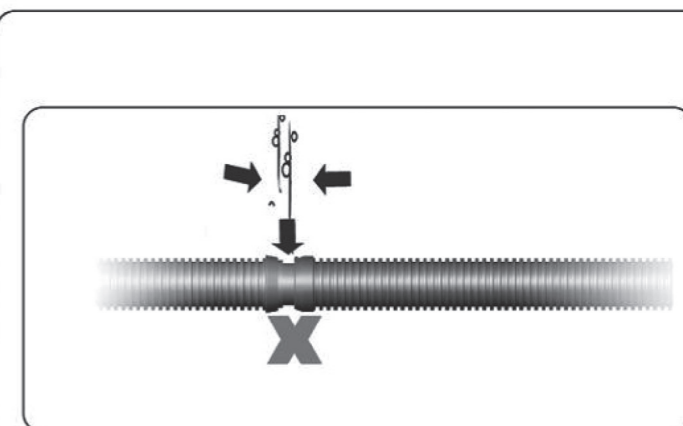
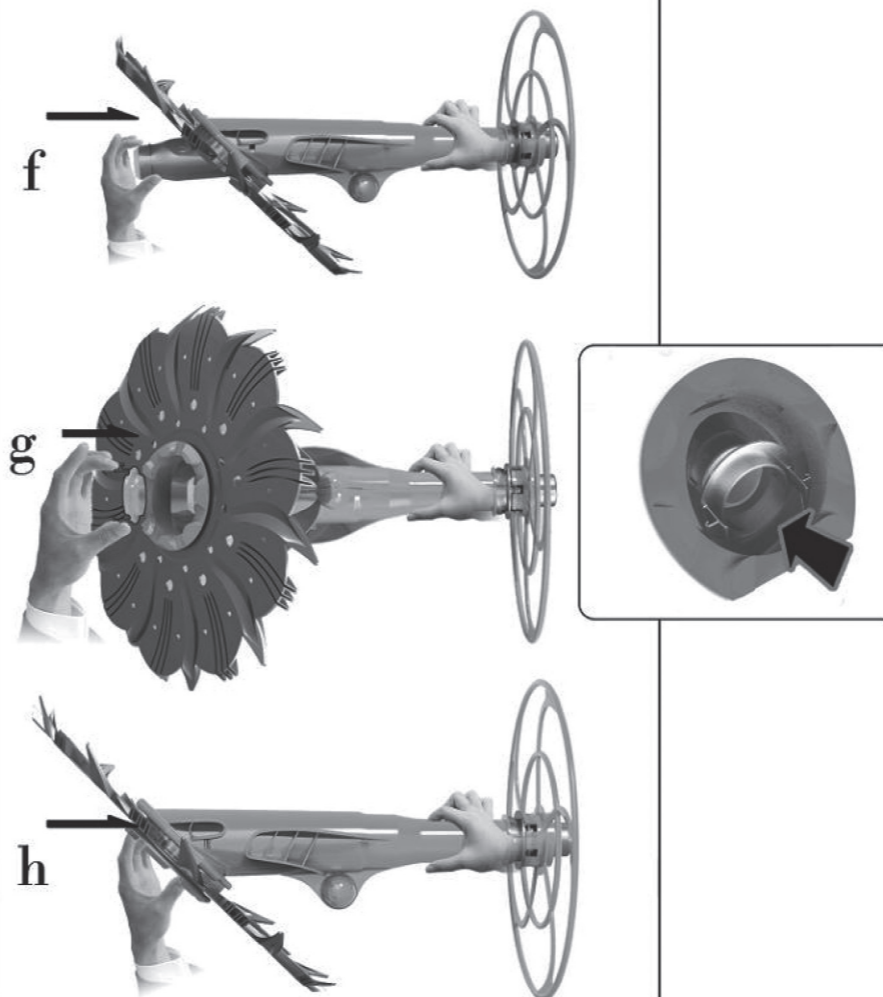

• Spojení hadic musí pevně těsnit.

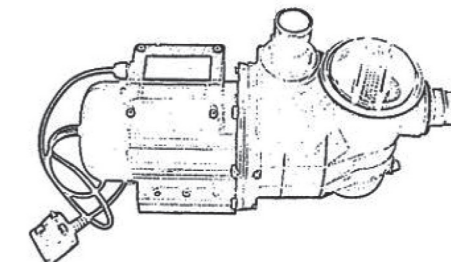
Min. 0,5HP/1000 galonů (3700 litrů)

• Čerpadlo filtrace by mělo mít výkon min. 0,5 HP/3700 litrů za hodinu.

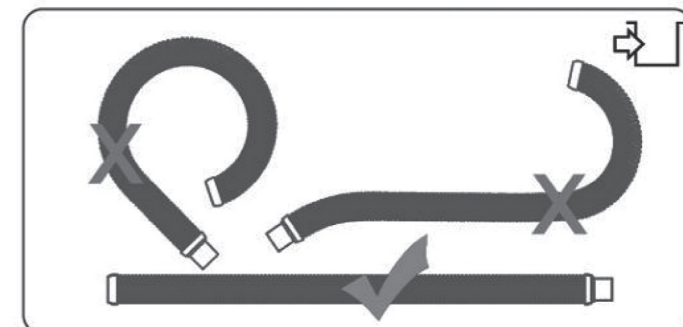

• Při skladování mějte hadice vždy uložené rovně a chráňte je před sluncem.

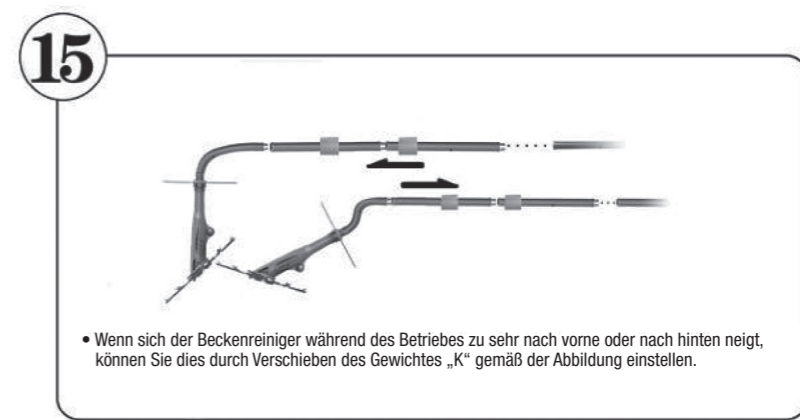
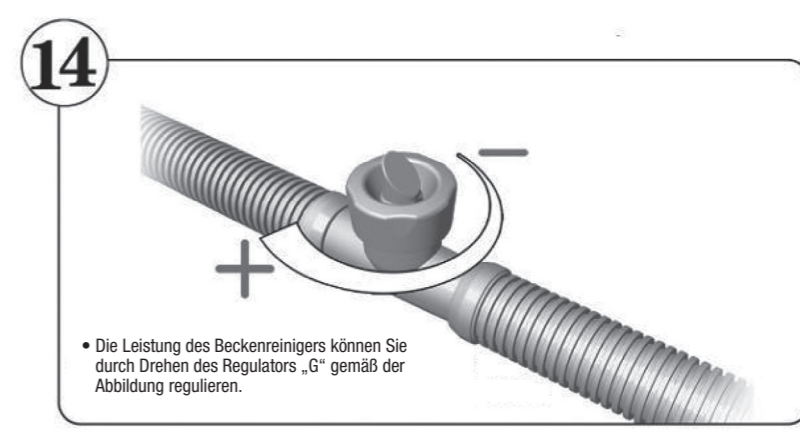
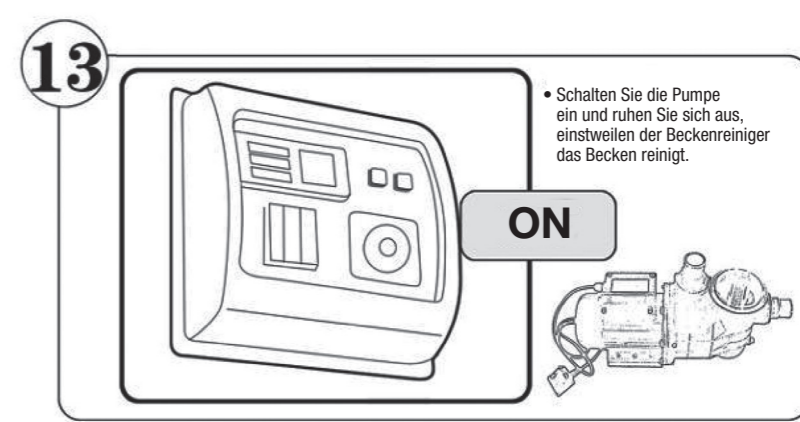
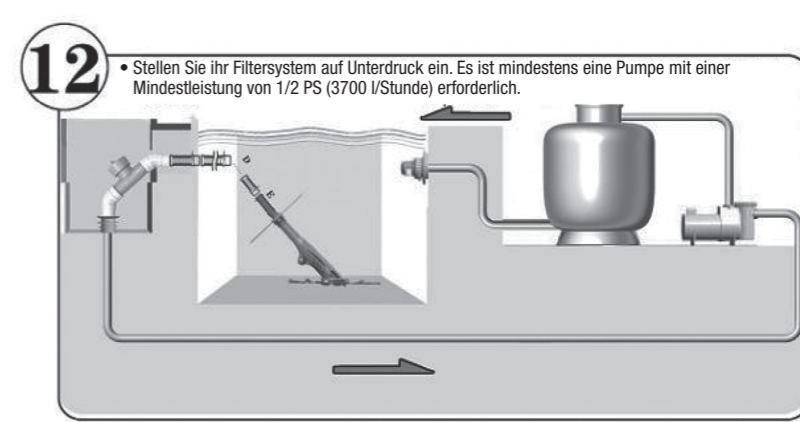
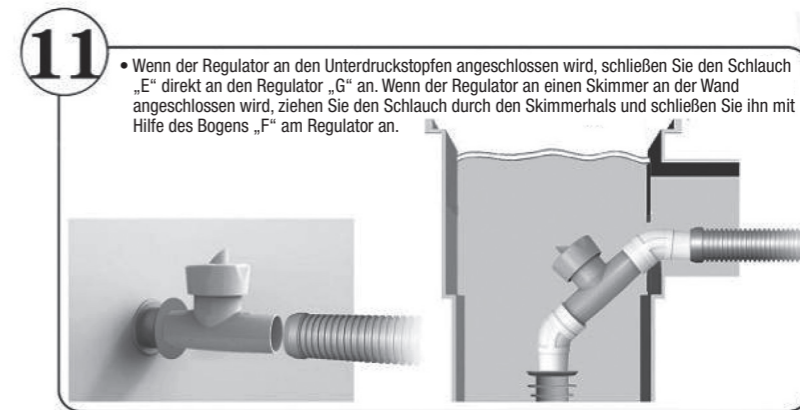
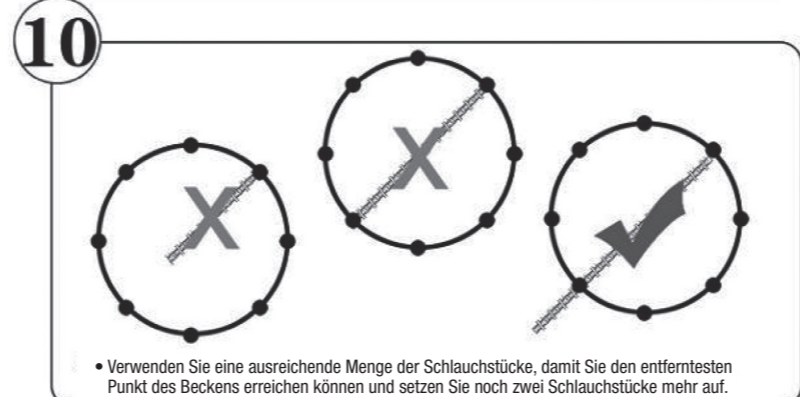
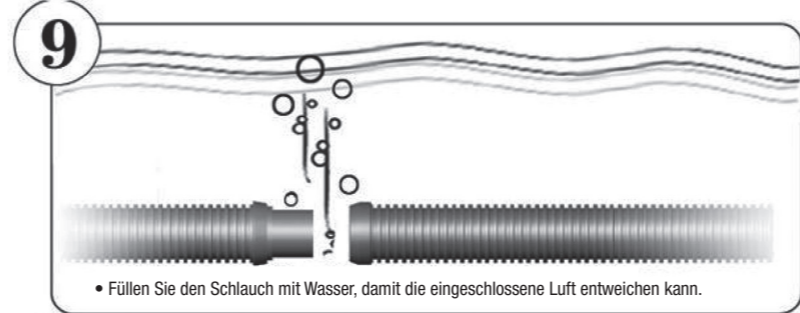
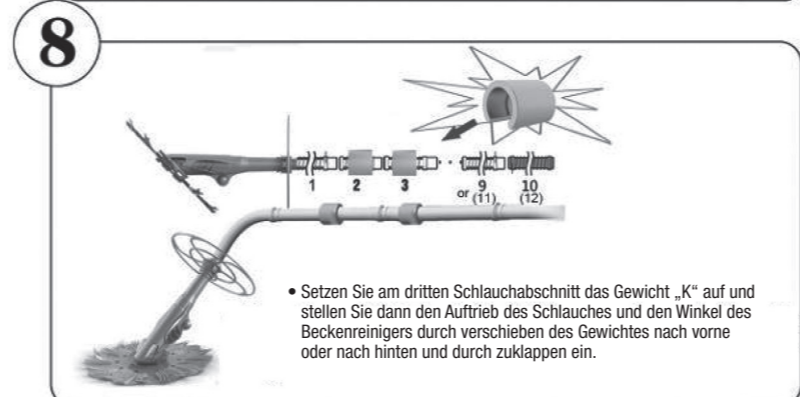
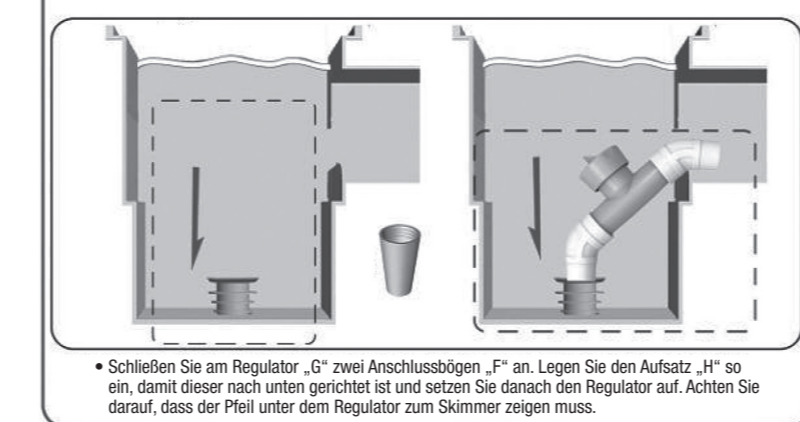
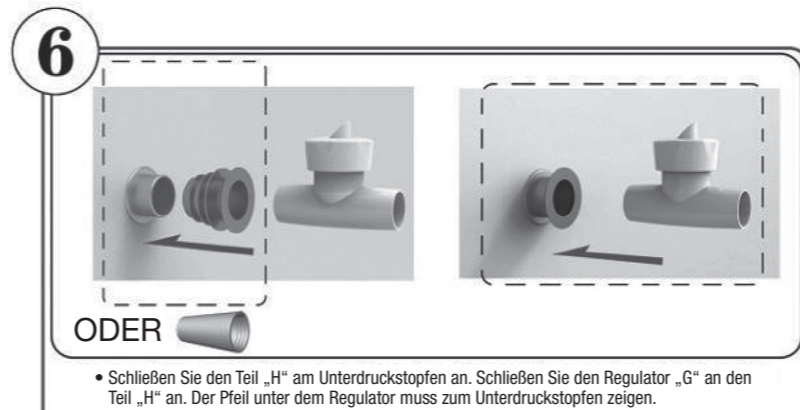
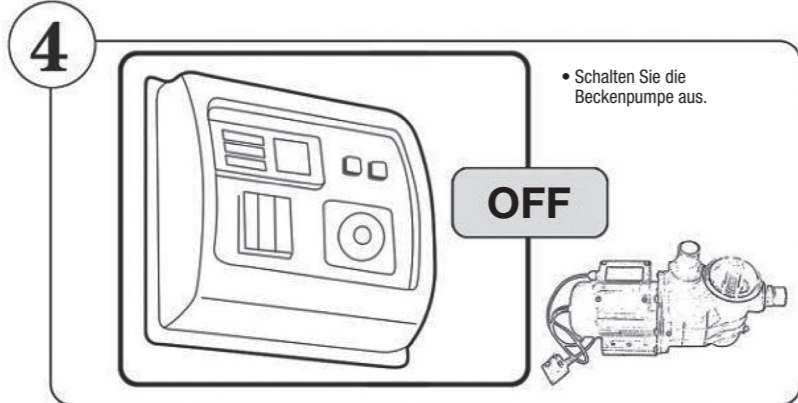
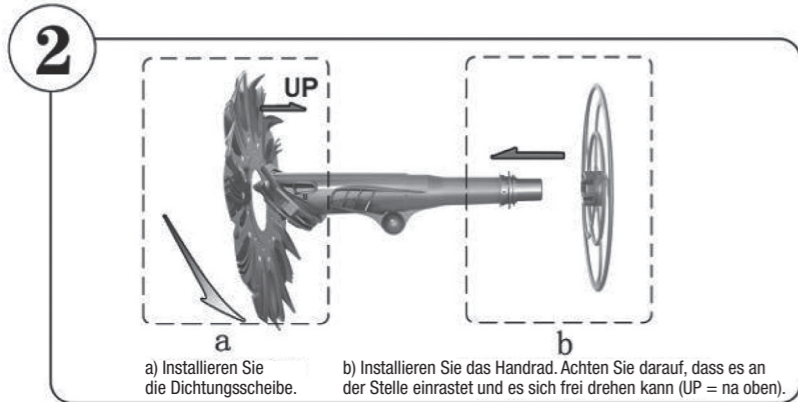
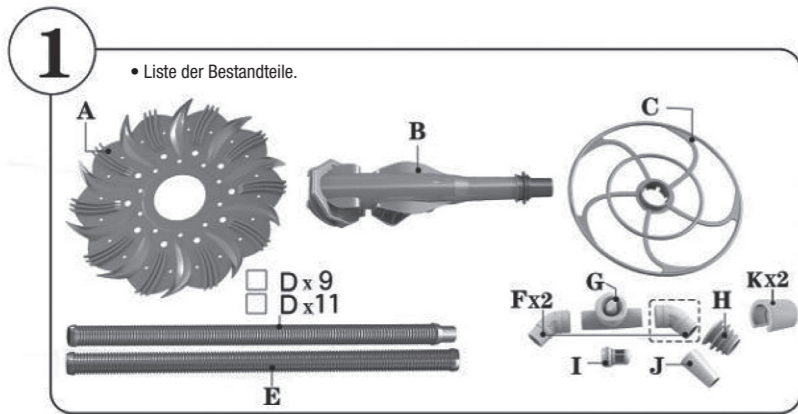

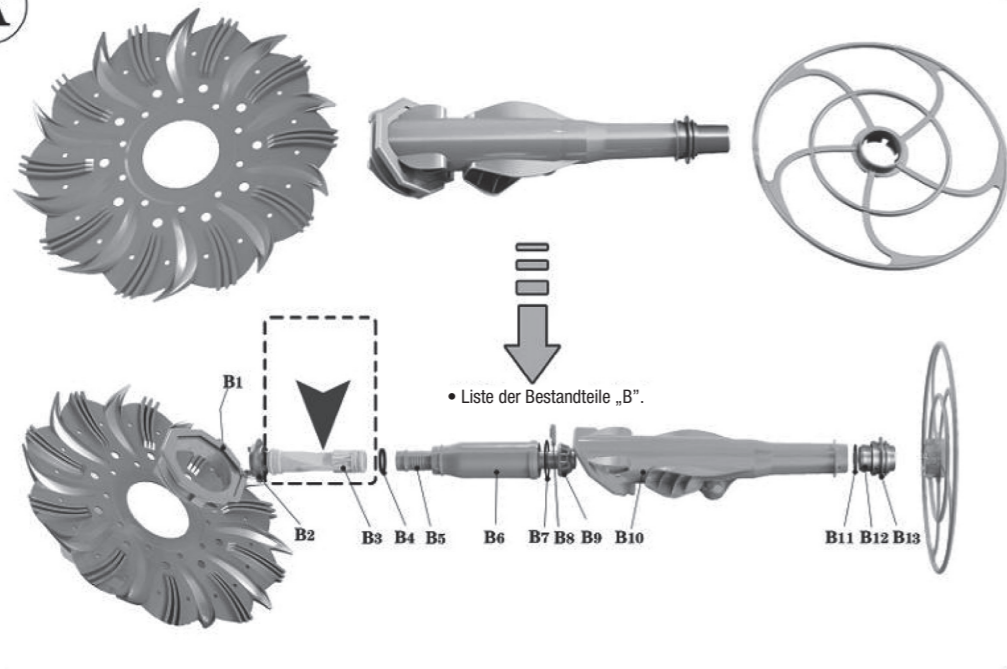
A

Die Membrane tauschen Sie wie folgt:

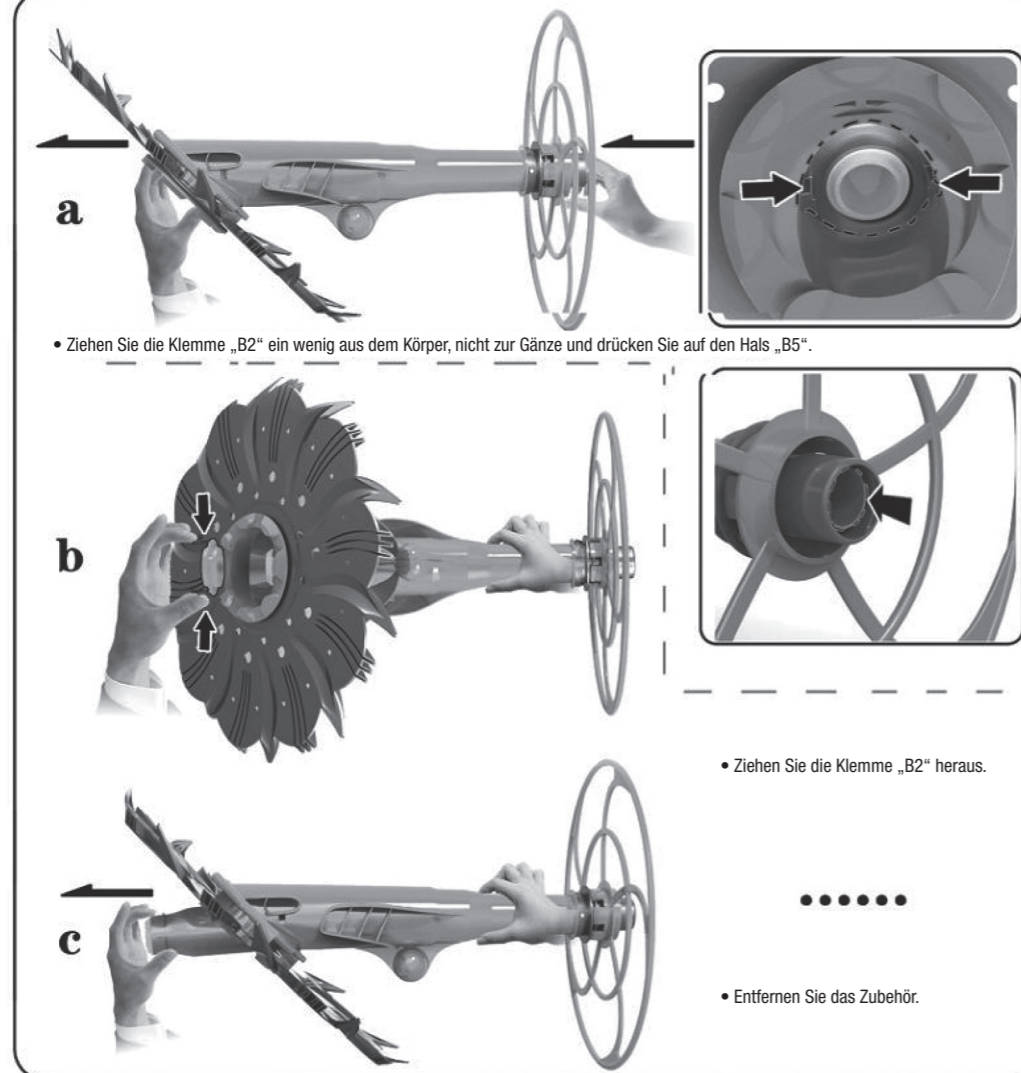
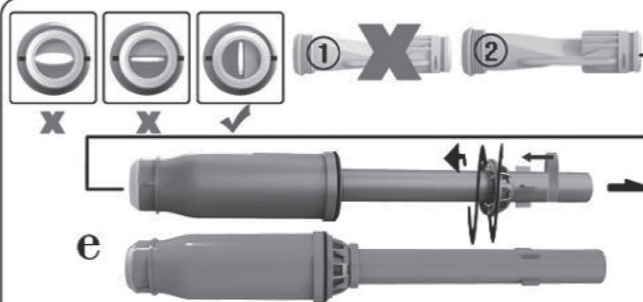
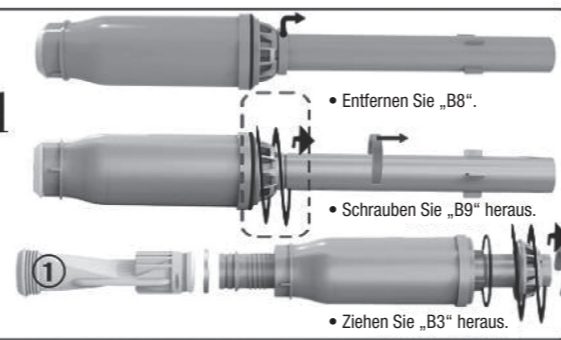
B**d**

• Installieren Sie die neue Membrane „2“, die Montage entspricht dem oben angeführten Punkt.

• Installieren Sie das Zubehör am Beckenreiniger auf die oben beschriebene Art.

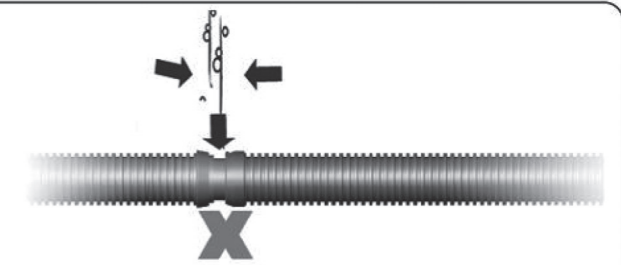
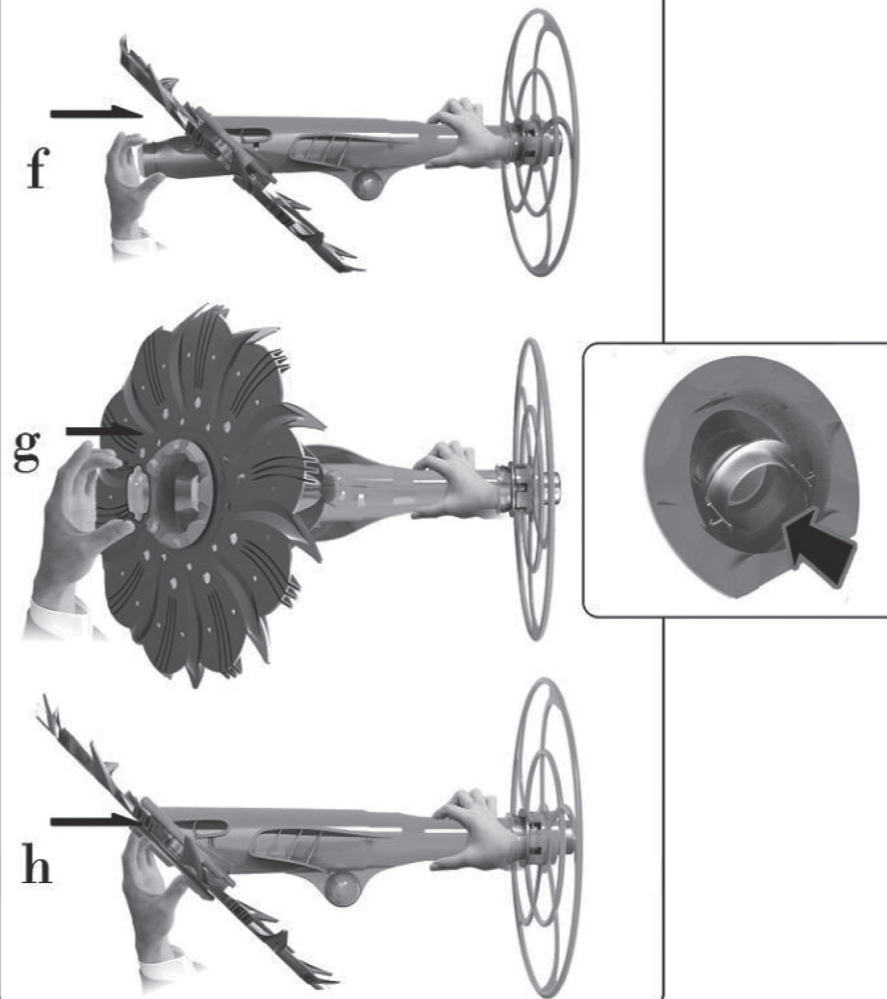

• An den Schlauchverbindungen dürfen keine Undichtheiten auftreten.

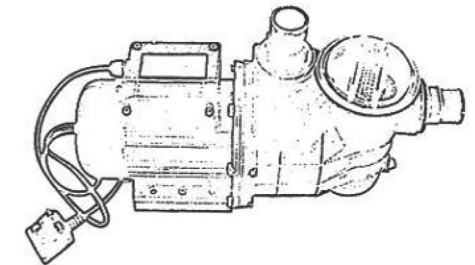
Min. 0,5HP/1000 gallonen (3700 Liter)

• Die Pumpe des Beckenreinigers sollte eine Mindestleistung von 0,5 HP/3700 Liter haben.

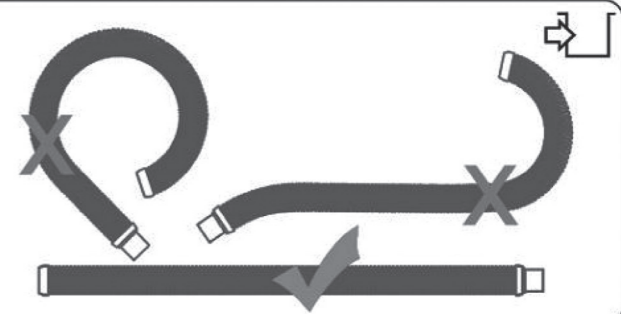

• Lagern Sie die Schlauchstücke immer gerade.

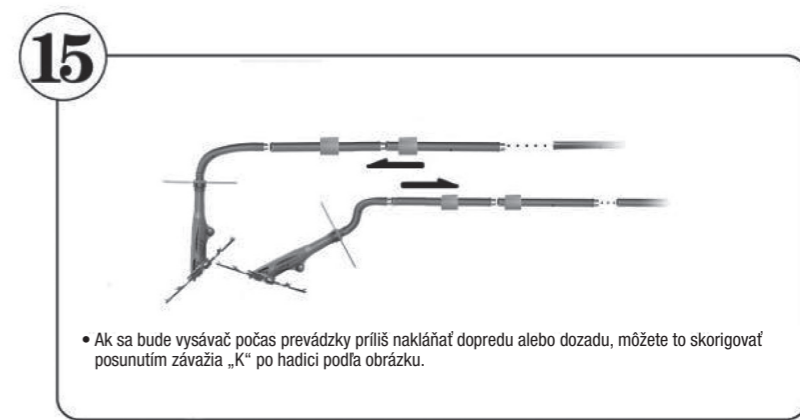
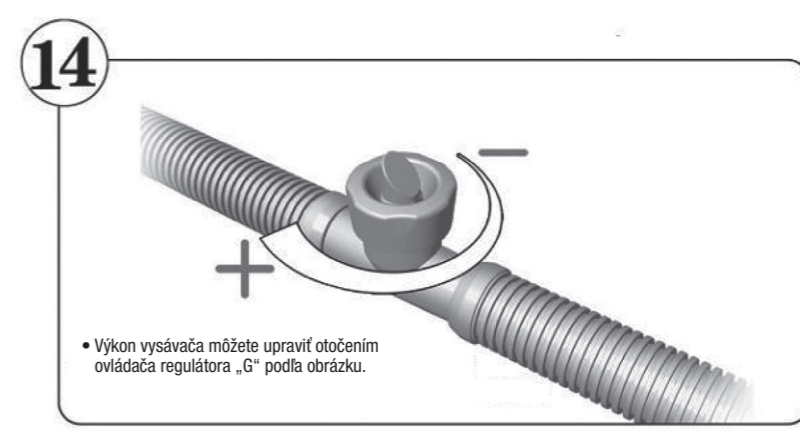
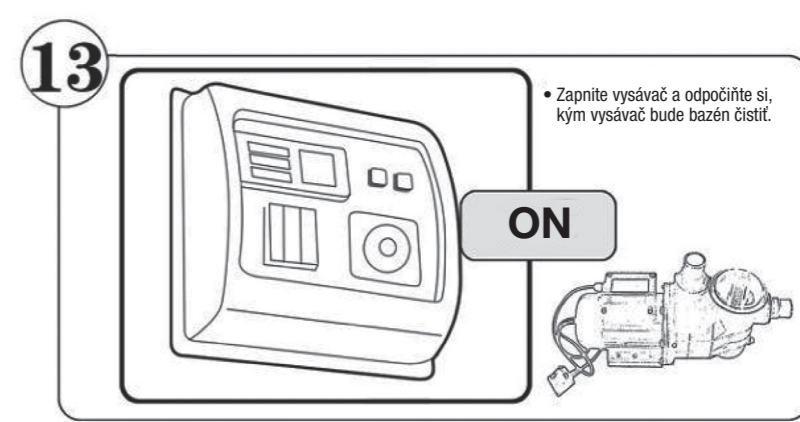
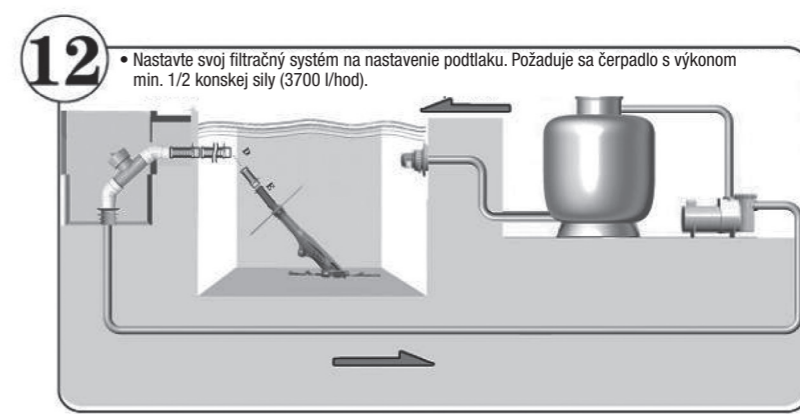
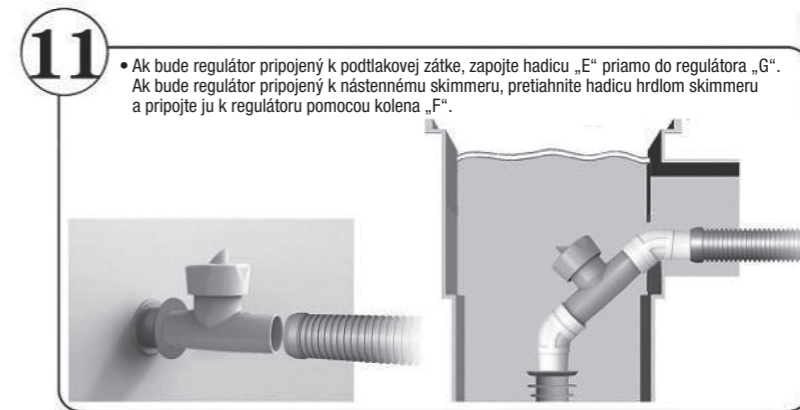
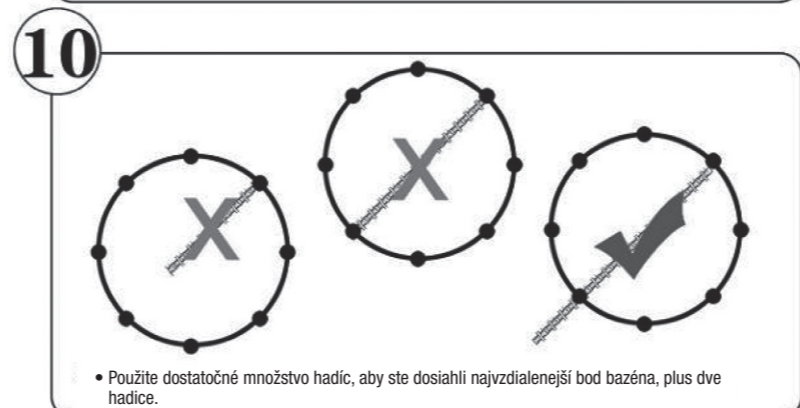
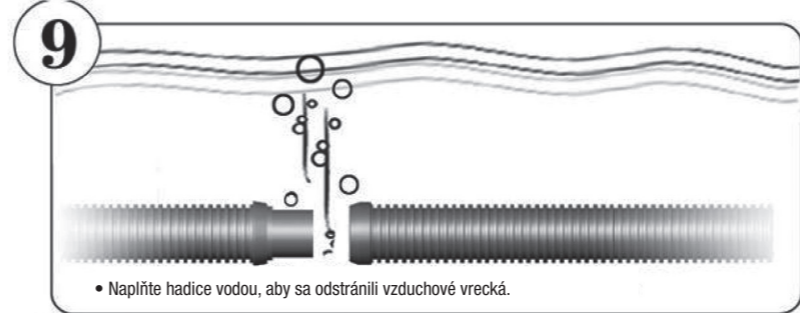
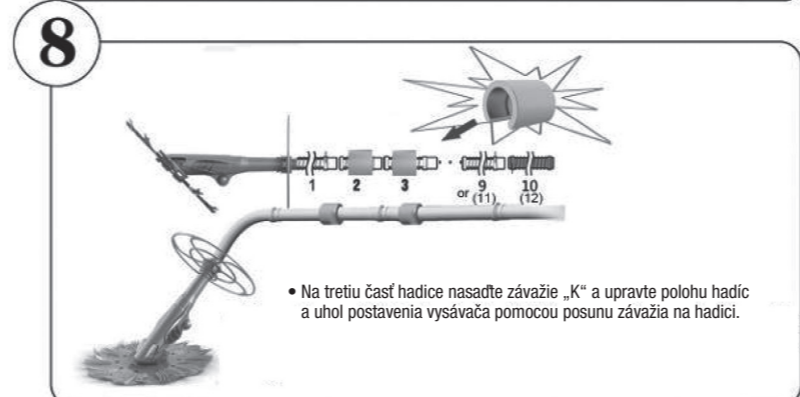
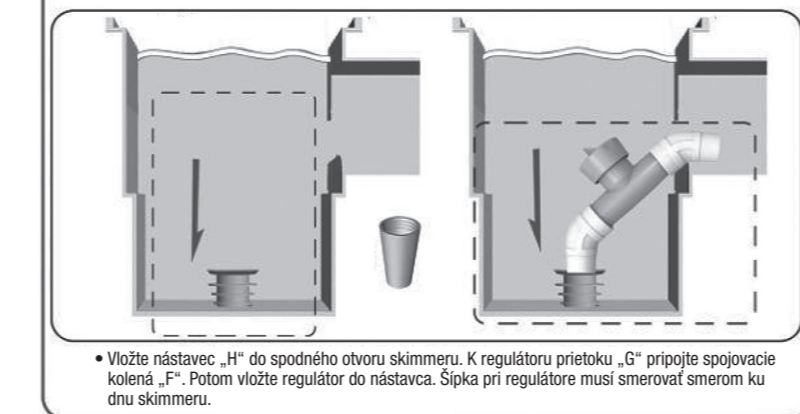
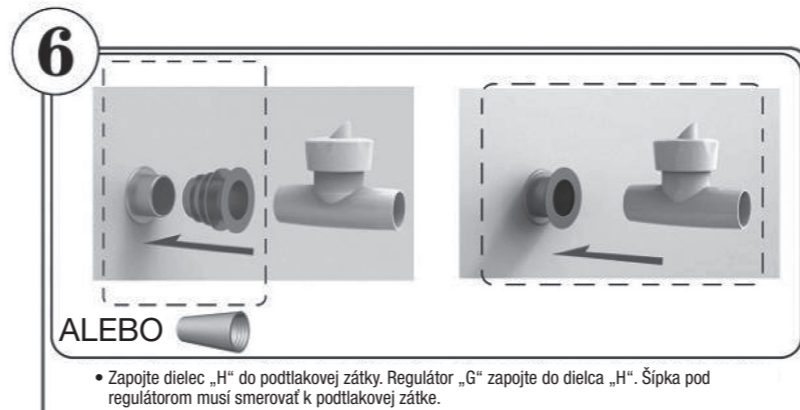
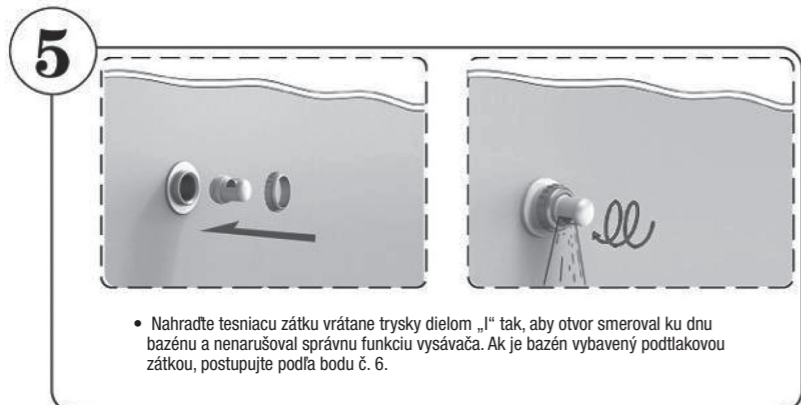
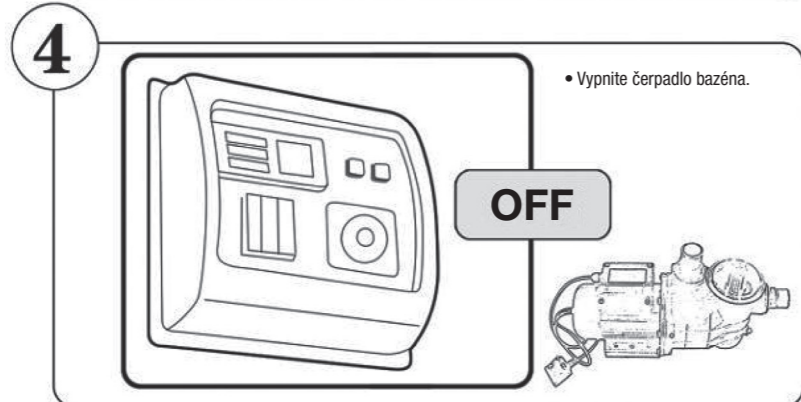
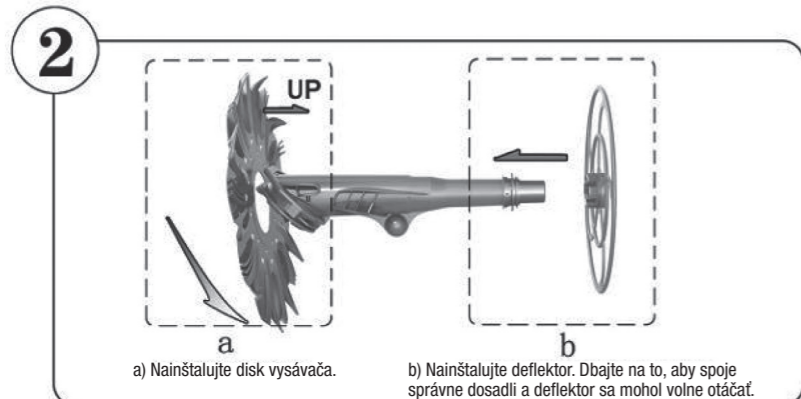
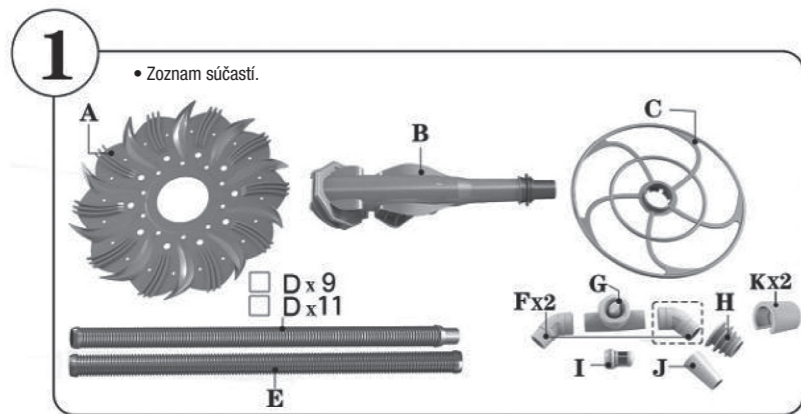

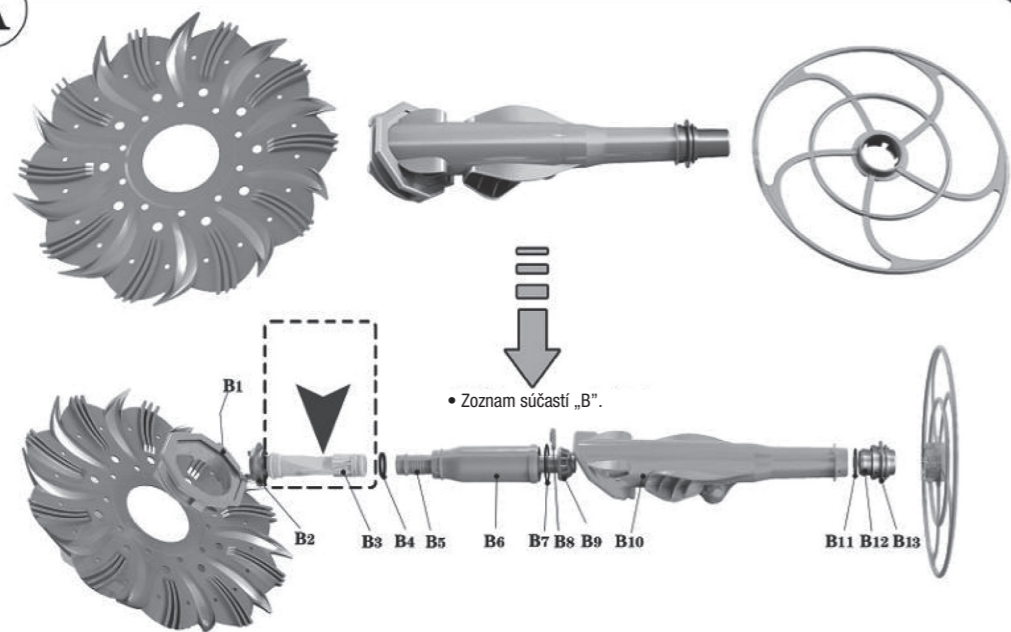
A

Vymeňte membránu nasledovne:

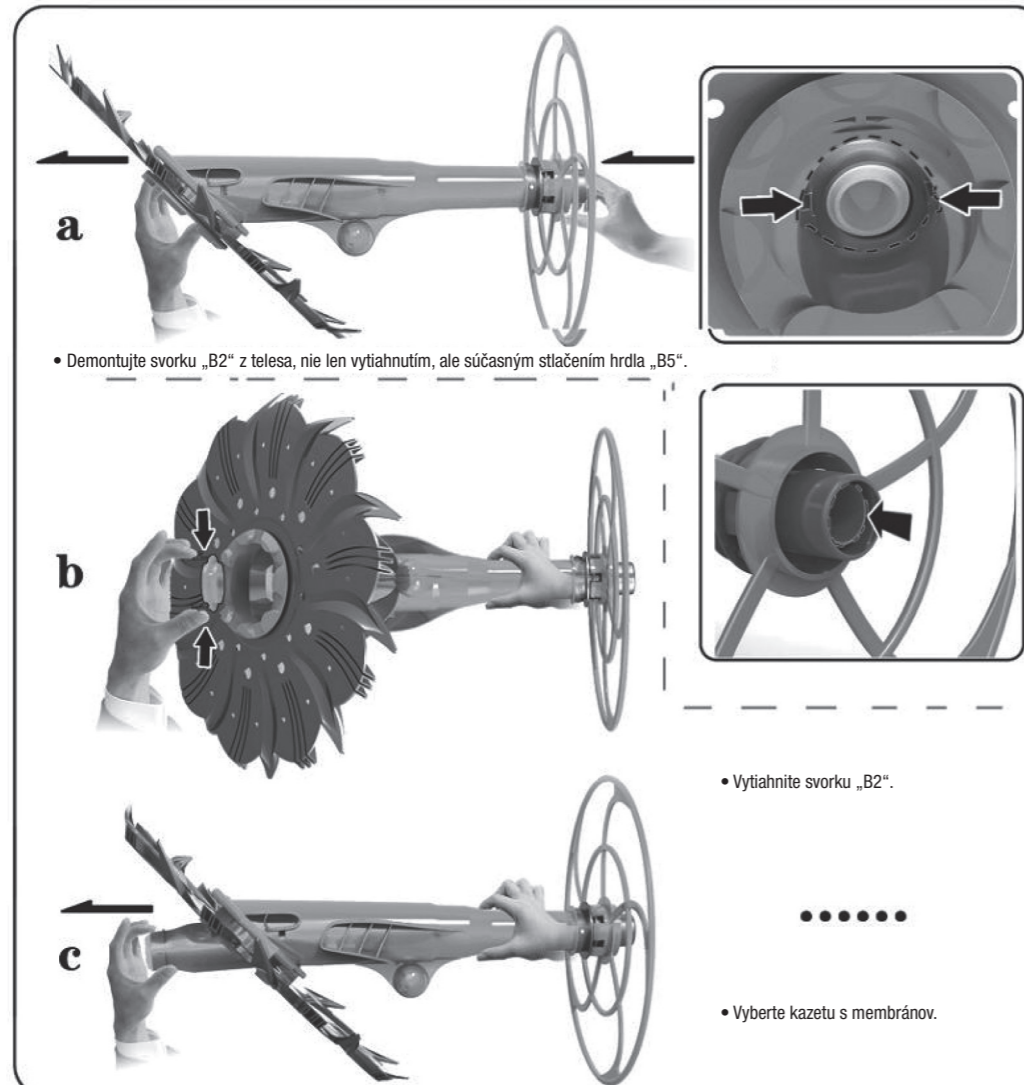
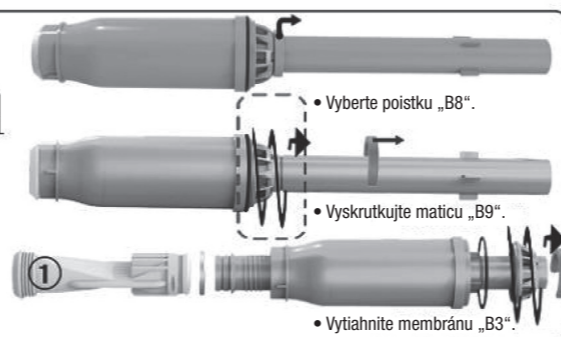
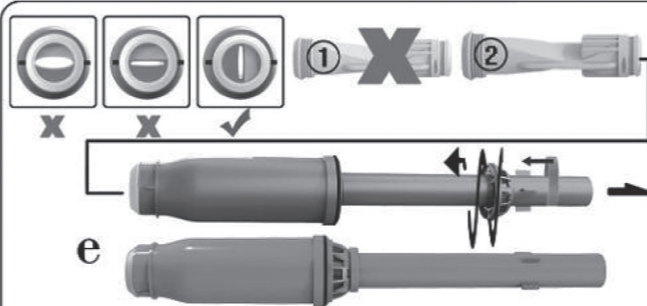
B**d****e****POZOR:**

1) Dielec „B9“ sa NESMIE príliš utahovať, inak sa membrána otvorí doširoka, čo má negatívny vplyv na jej výkon.
2) Membrána musí byť umiestená na rovnakom vedení ako teleso „B6“.

• Nainštalujte diely vysávača nižšie uvedeným spôsobom.

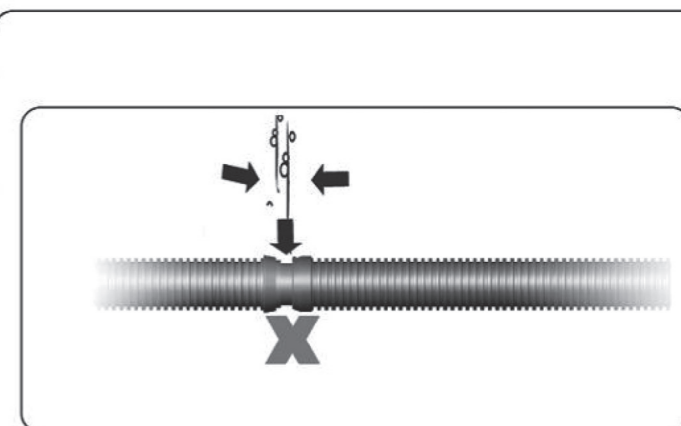
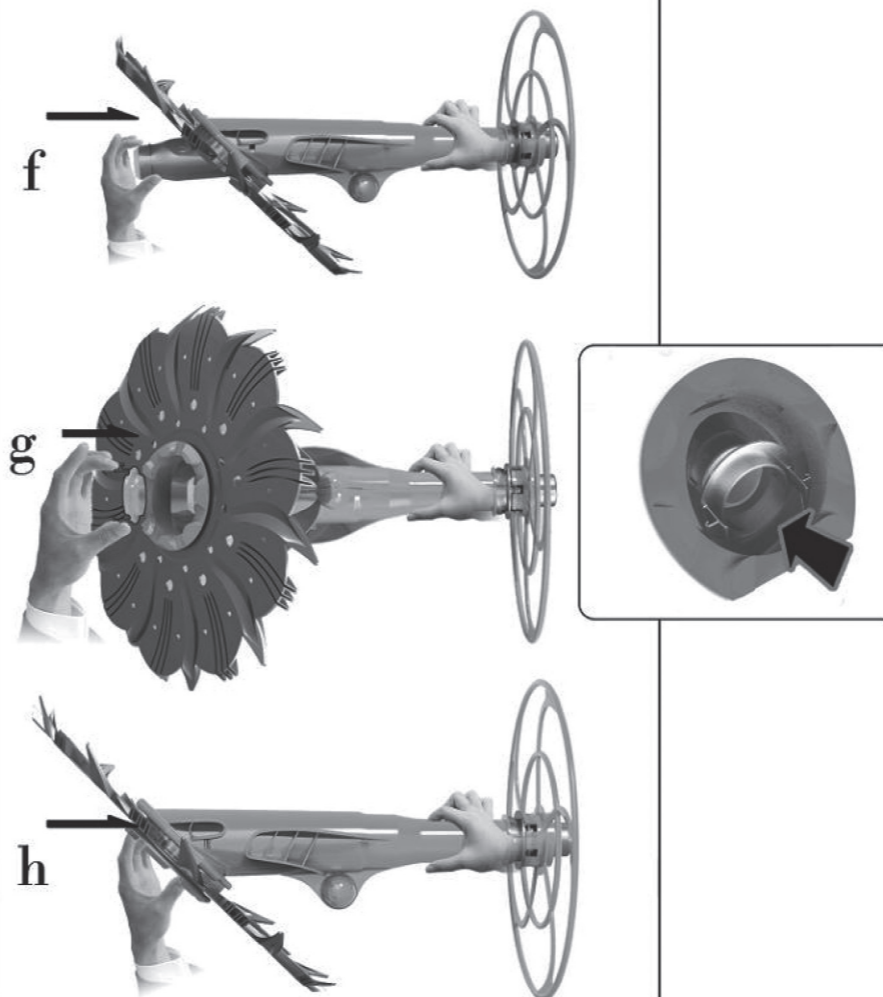

• Spojenie hadíc musí pevne tesniť.

Min. 0,5HP/1000 galónov (3700 litrov)

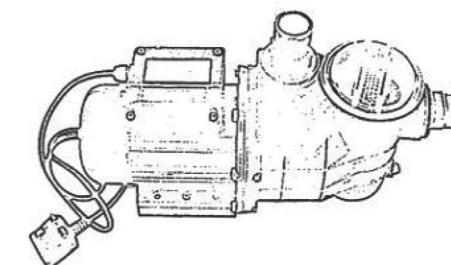

• Čerpadlo filtrácie by malo mať výkon min. 0,5 HP/3700 litrov za hodinu.

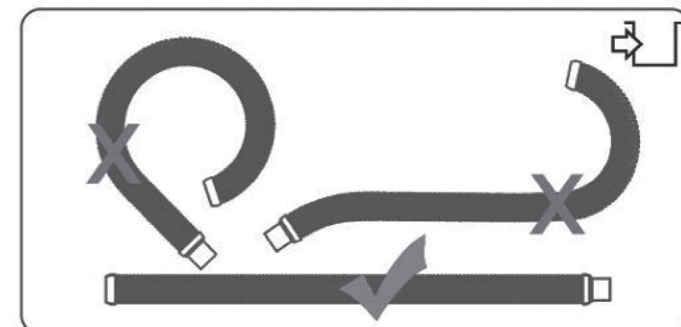

• Pri skladovaní majte hadice vždy uložené rovno a chráňte ich pred slnkom.

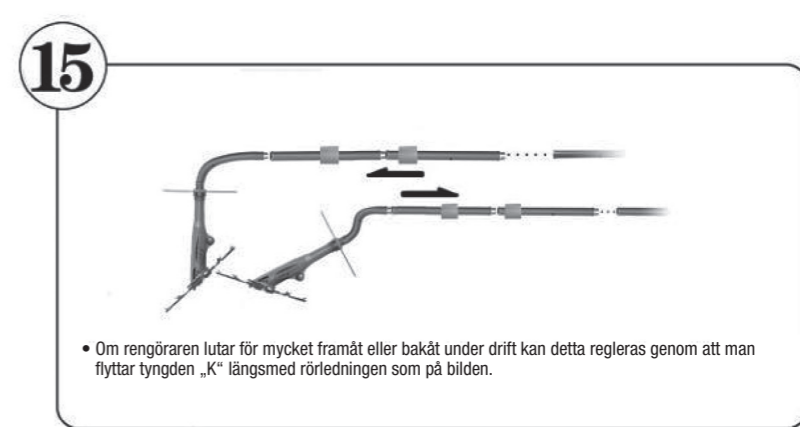
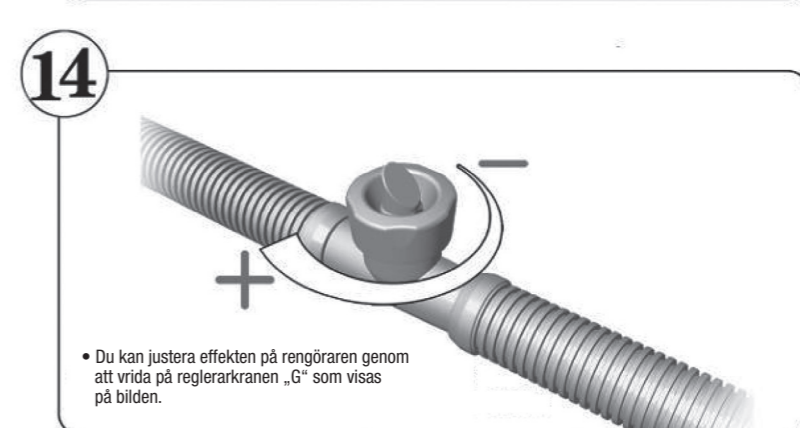
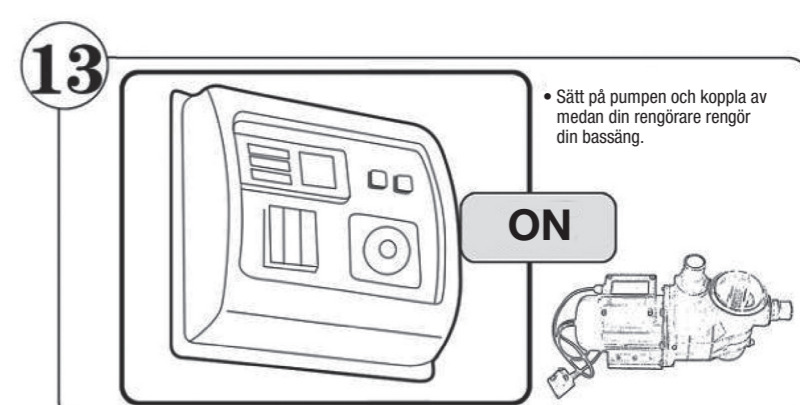
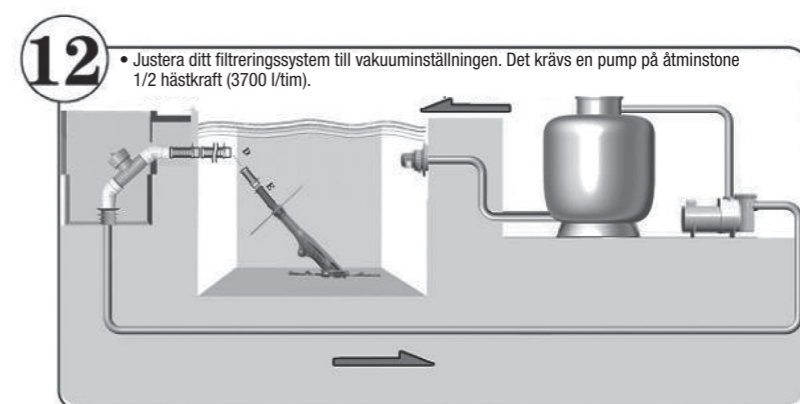
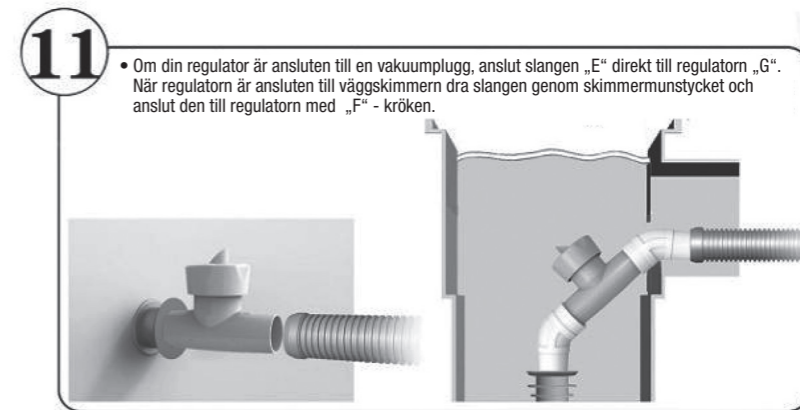
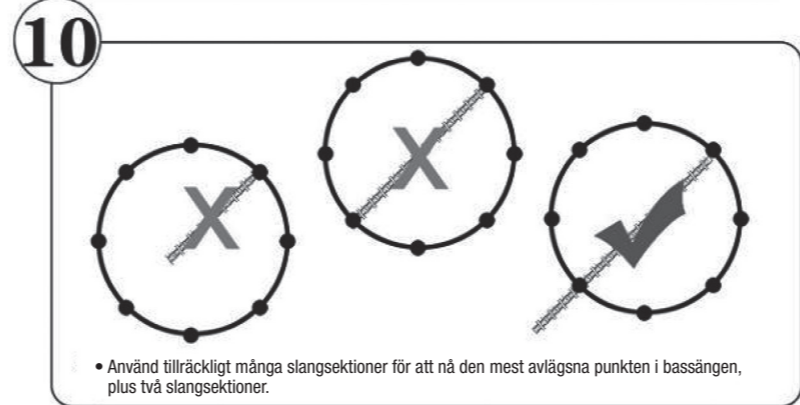
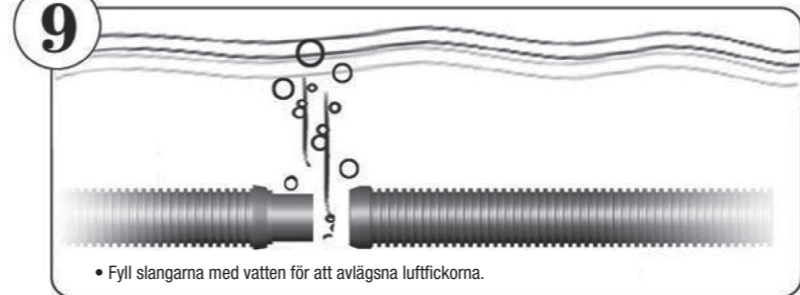
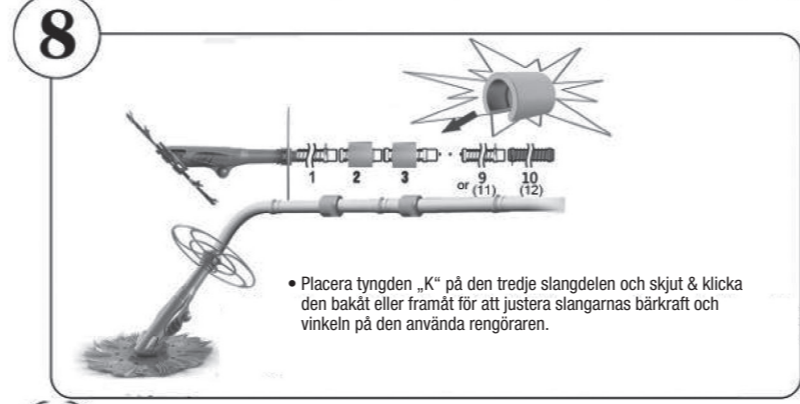
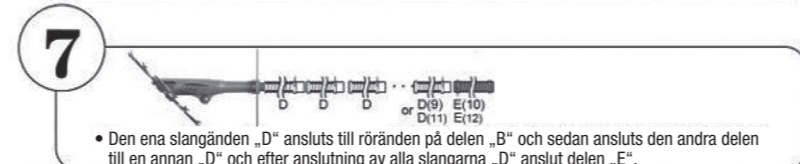
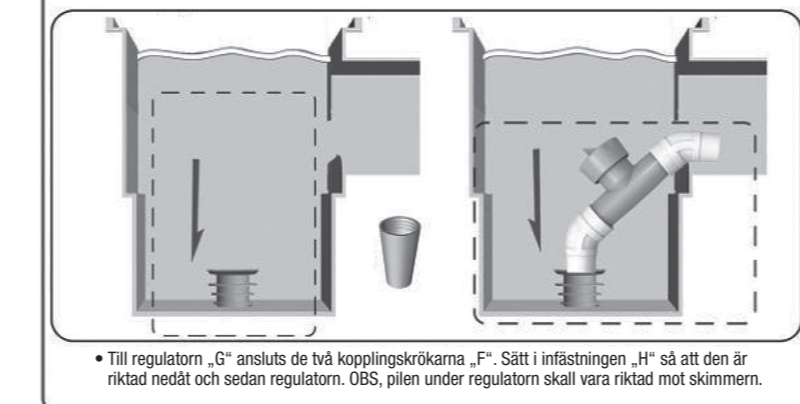
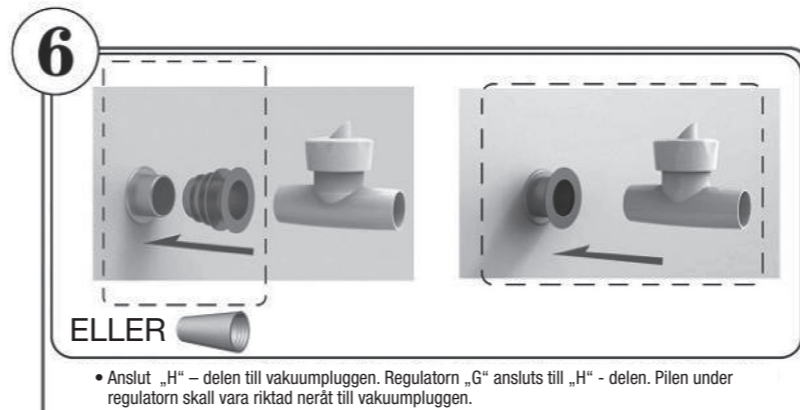
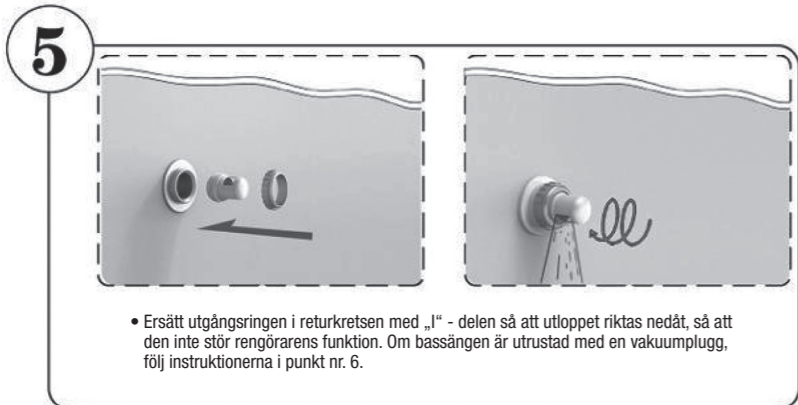
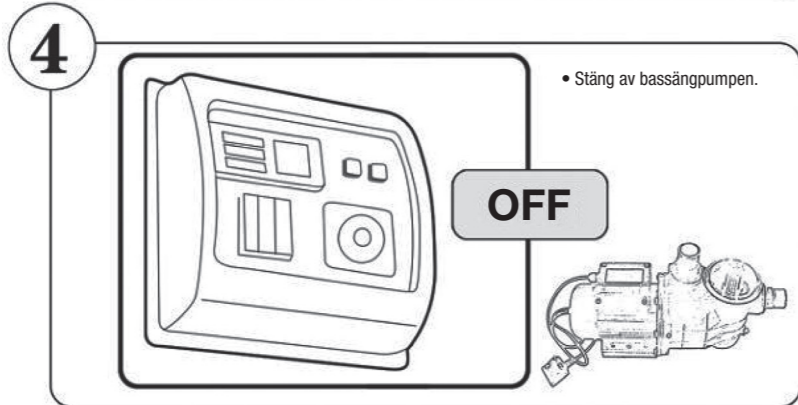
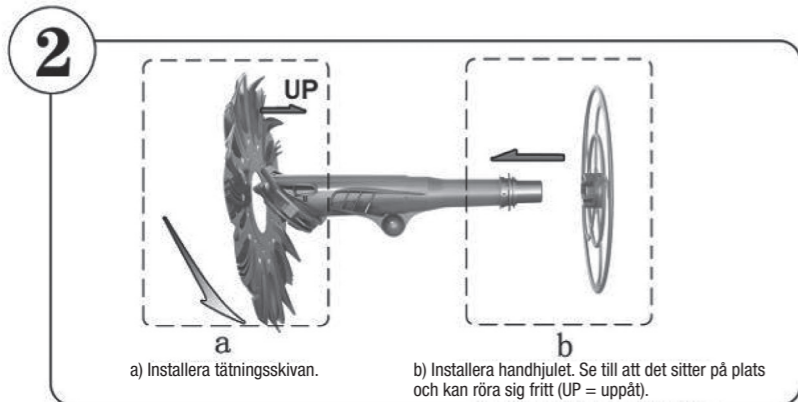
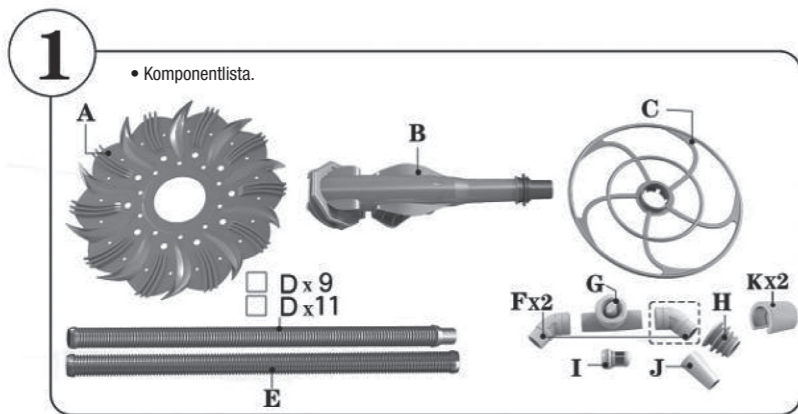

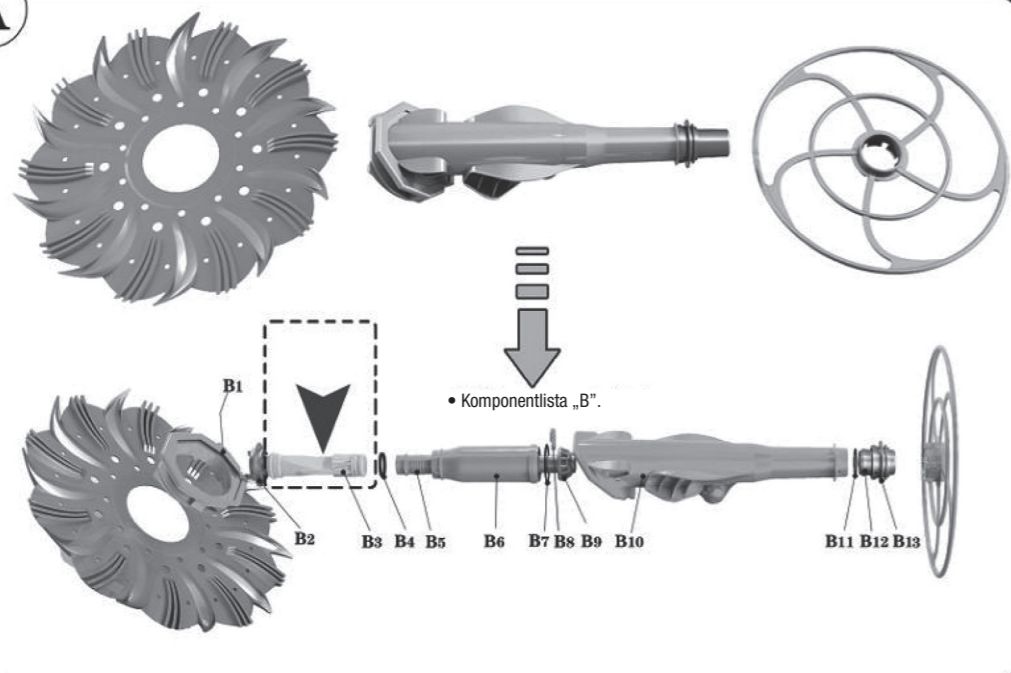
A

Byt membran på följande sätt:

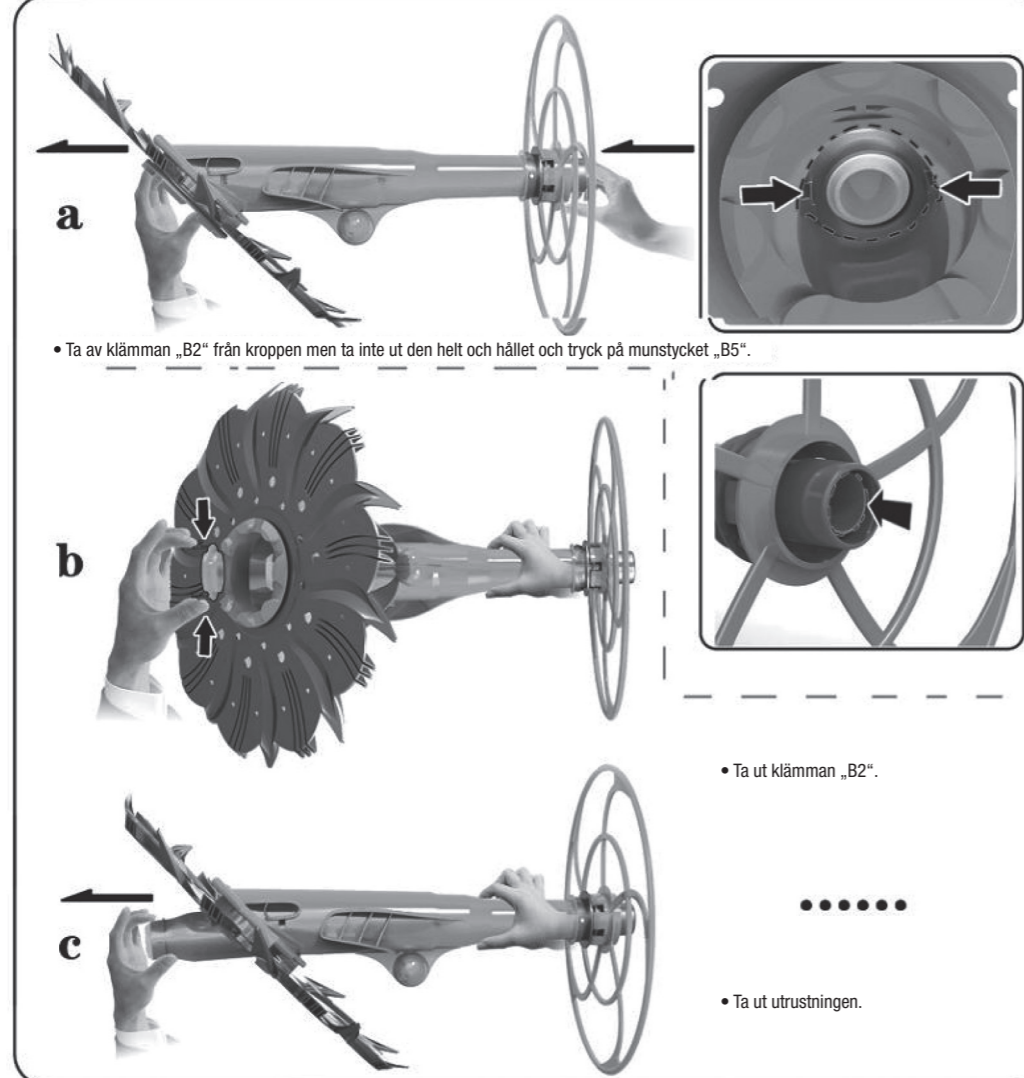
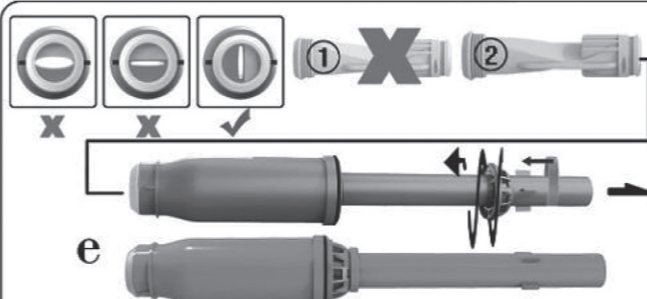
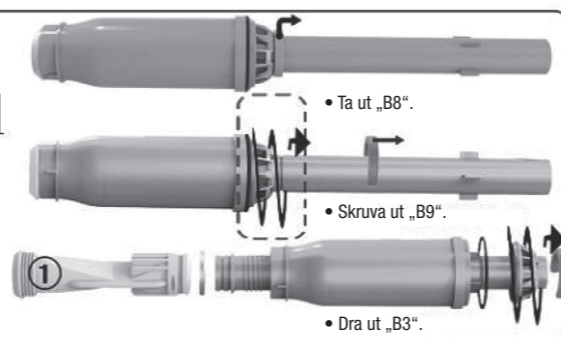
B**d****OBS:**

- 1) Delen „B9“ får INTE dras åt för hårt, annars kan membranet öppnas brett vilket har en negativ verkan på dess funktion.
- 2) Se till ärr membranet är placerat i linje med kroppen „B6“.

• Installera det nya membranet "2", installeringen är den samma som ovan.

• Installera utrustningen i rengöraren på sättet som anges ovan.

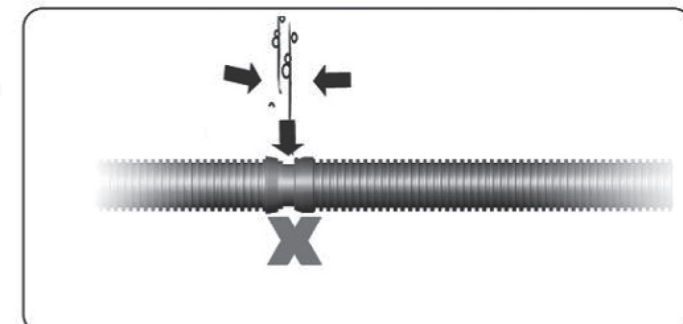
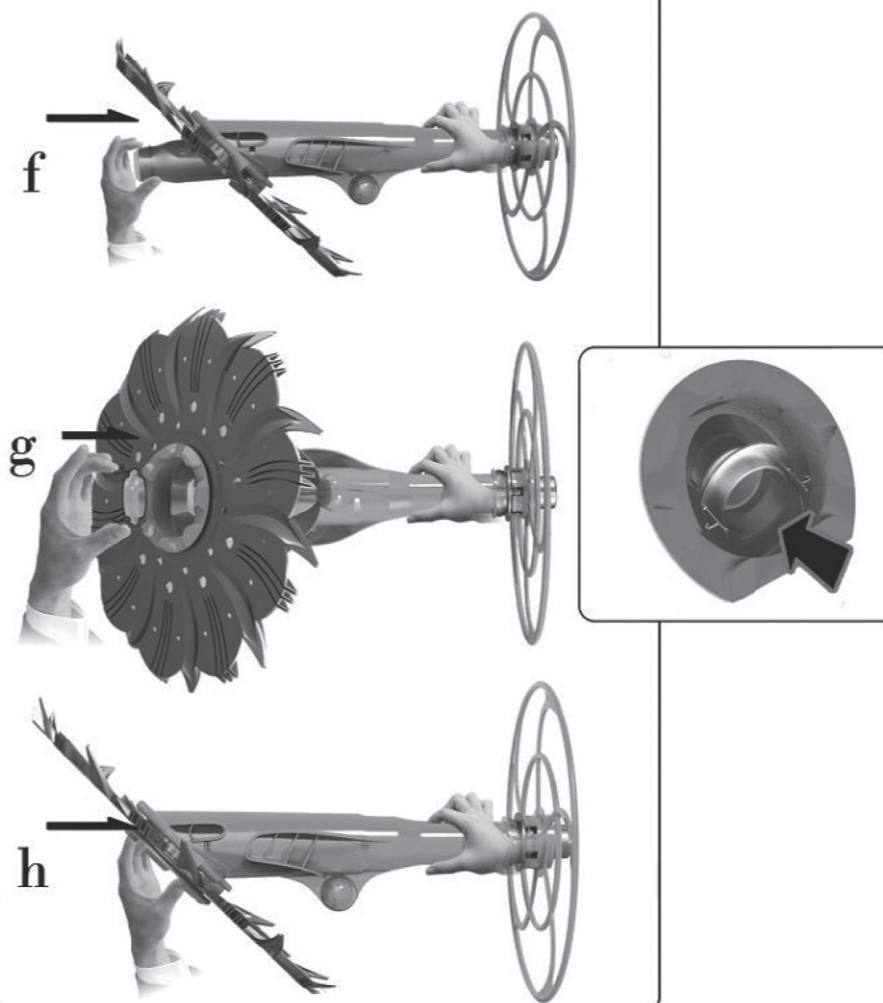

• Det får inte uppstå något läckage i röranlutningarna.

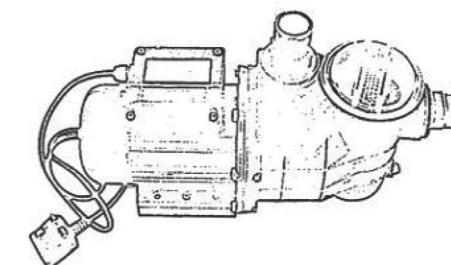
Minst 0.5HP/1000 gallons (3700 liter)

• Rengörarens pump skall ha en effekt på minst 0,5 HP/3700 liter.

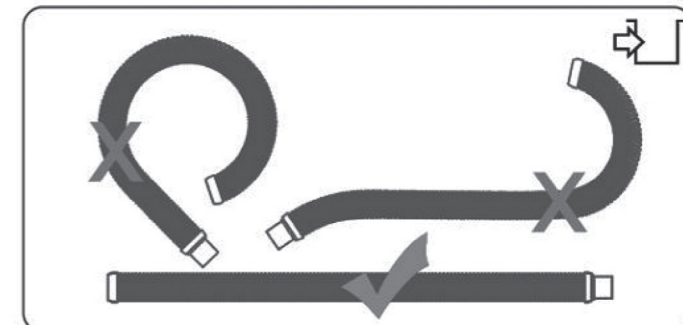

• Se till att slangarna alltid ligger rakt vid förvaring.

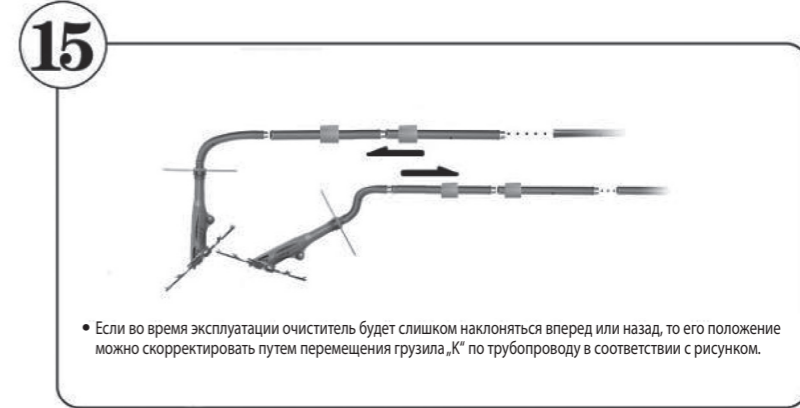
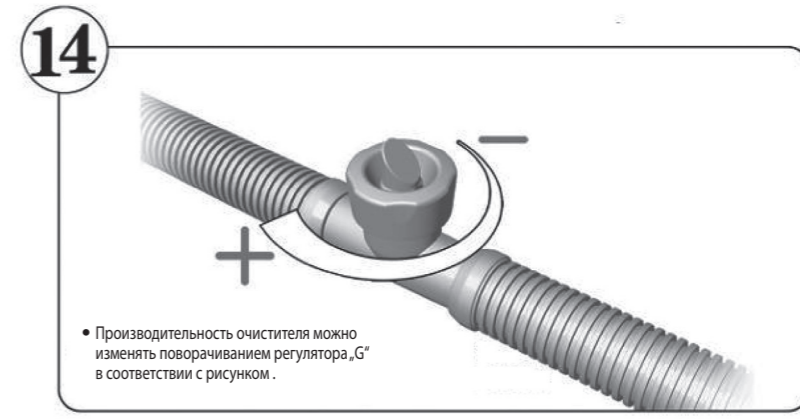
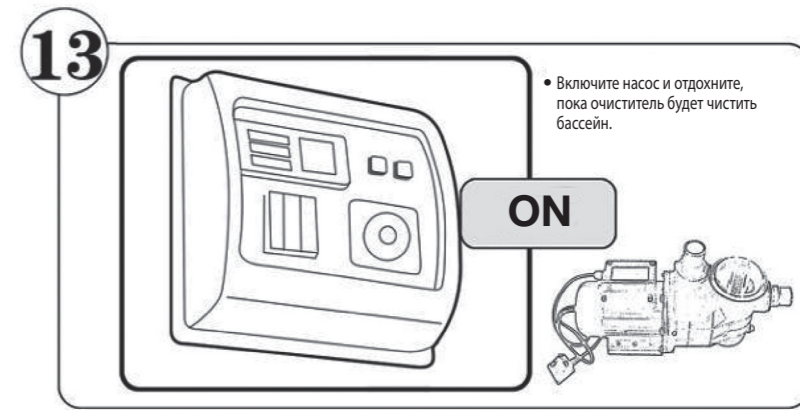
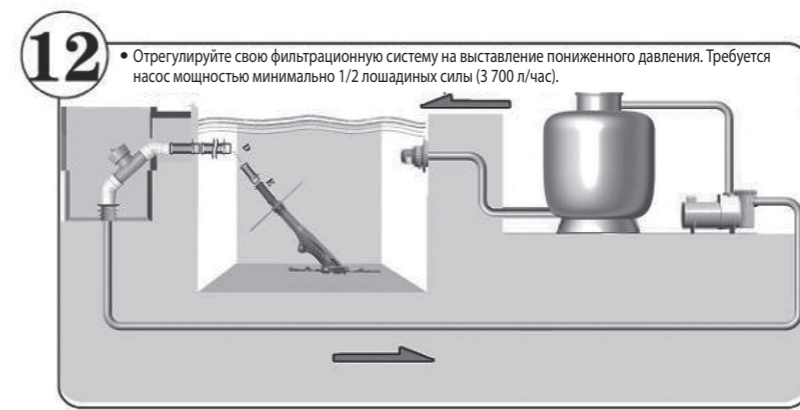
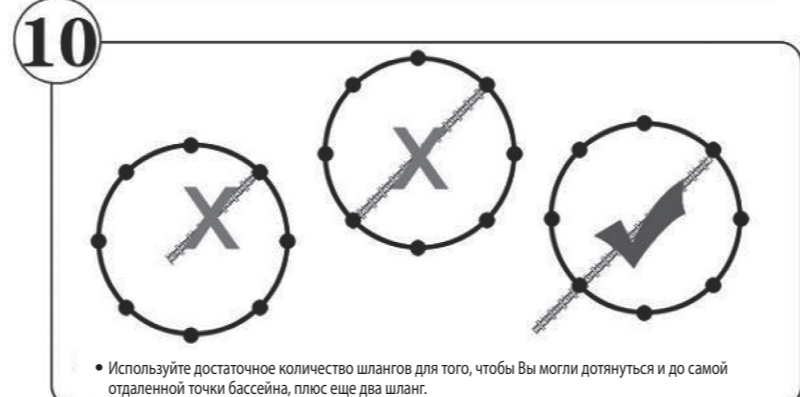
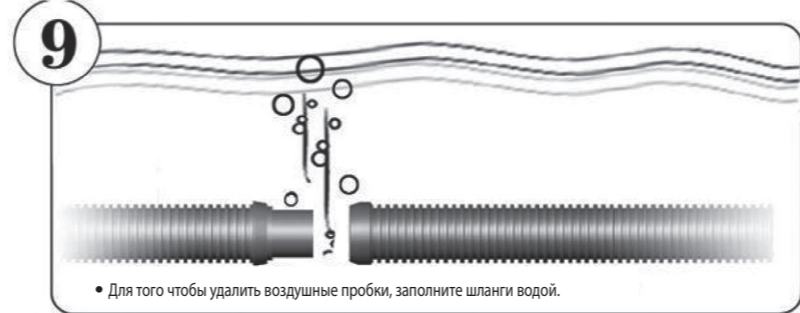
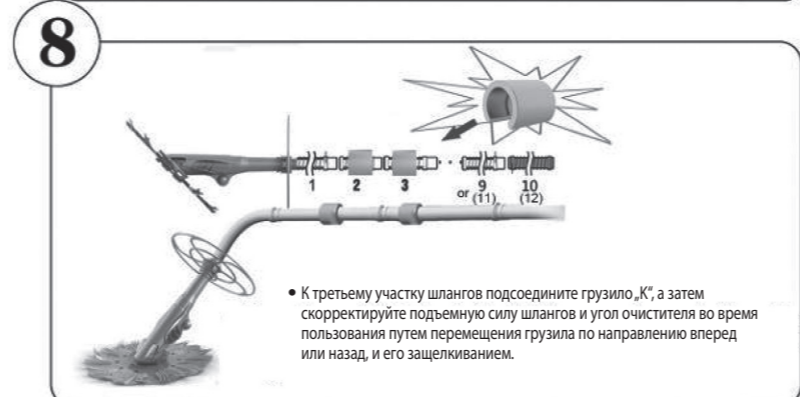
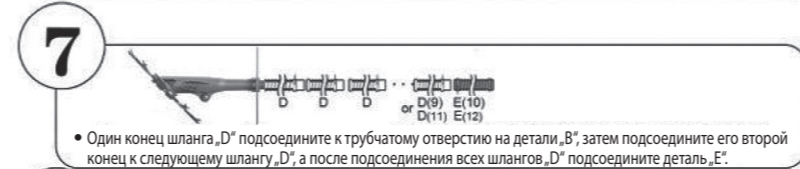
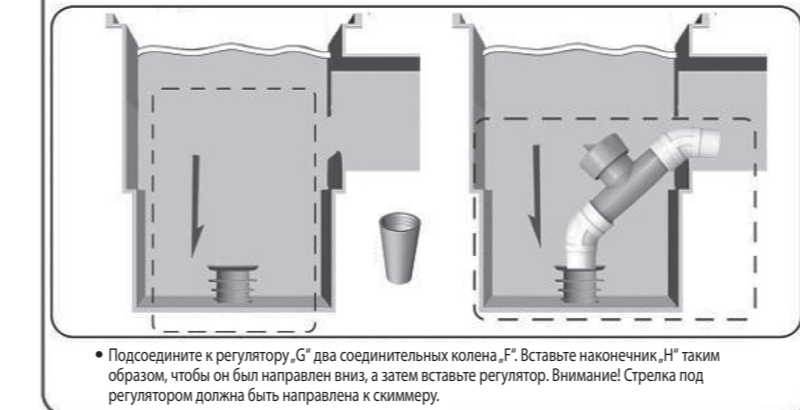
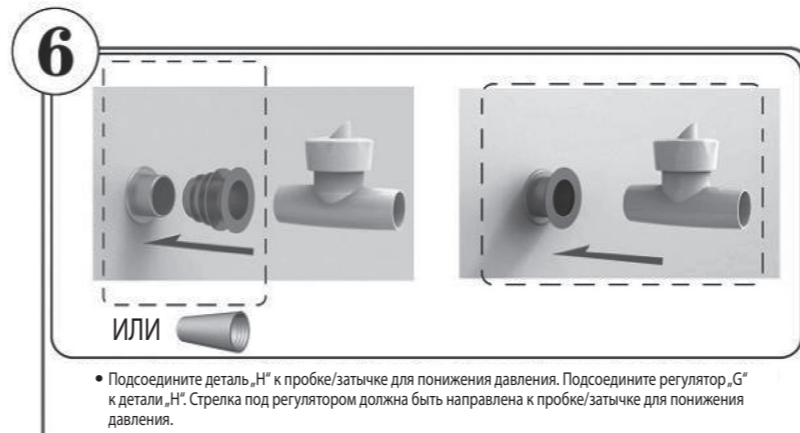
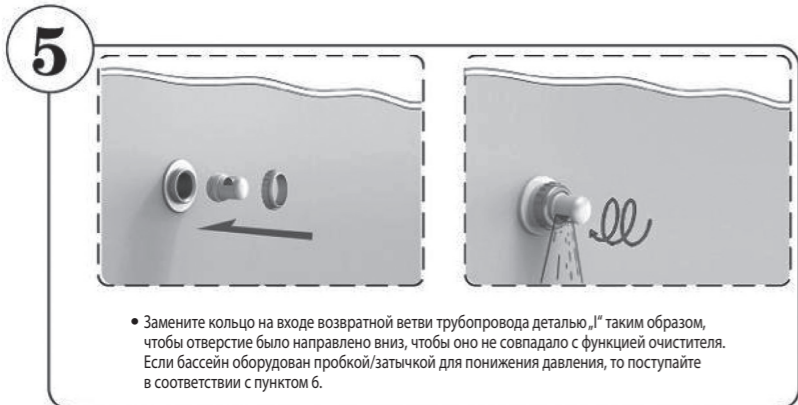
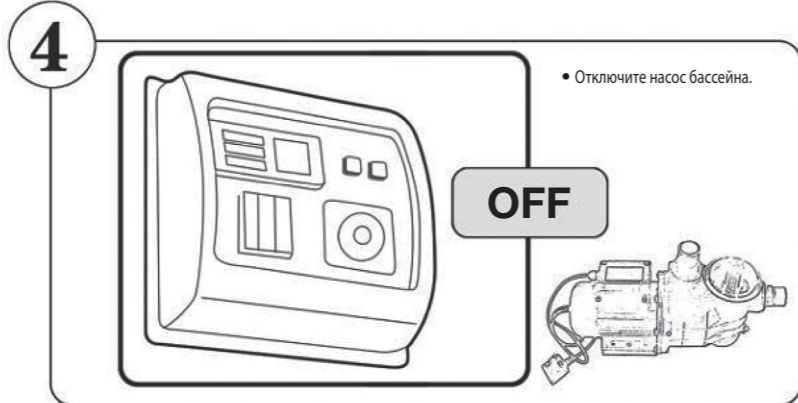
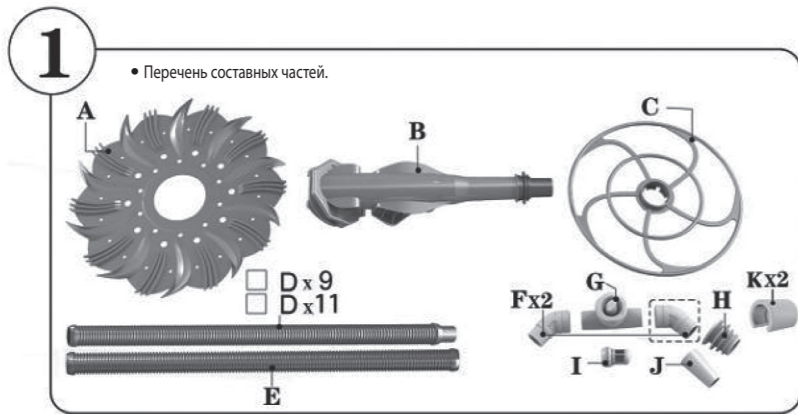

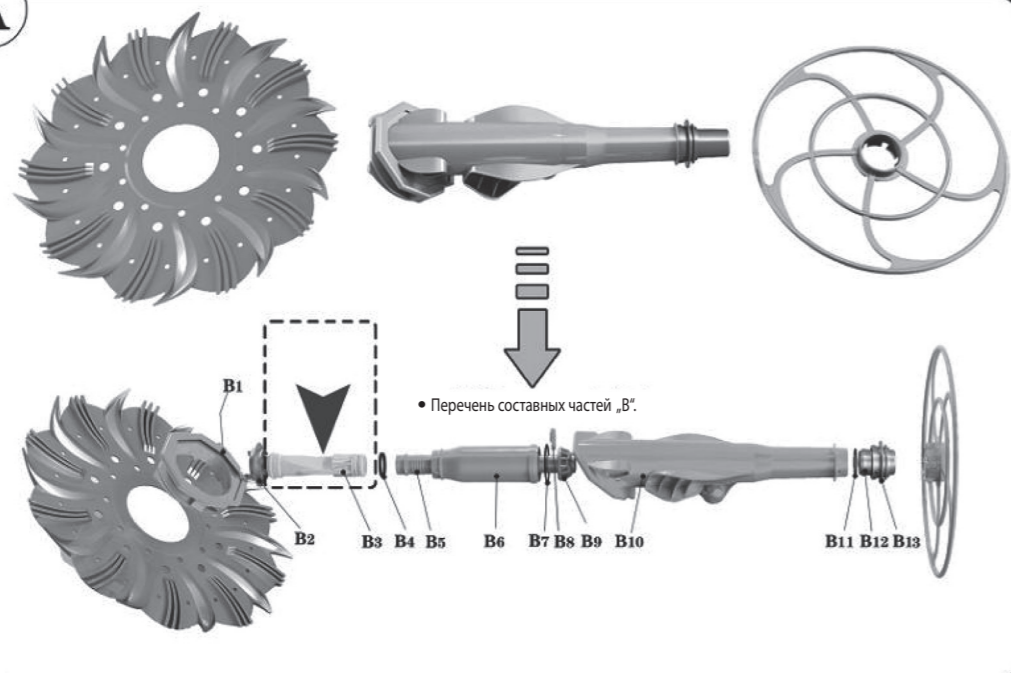
A

Замените мембрану следующим образом:

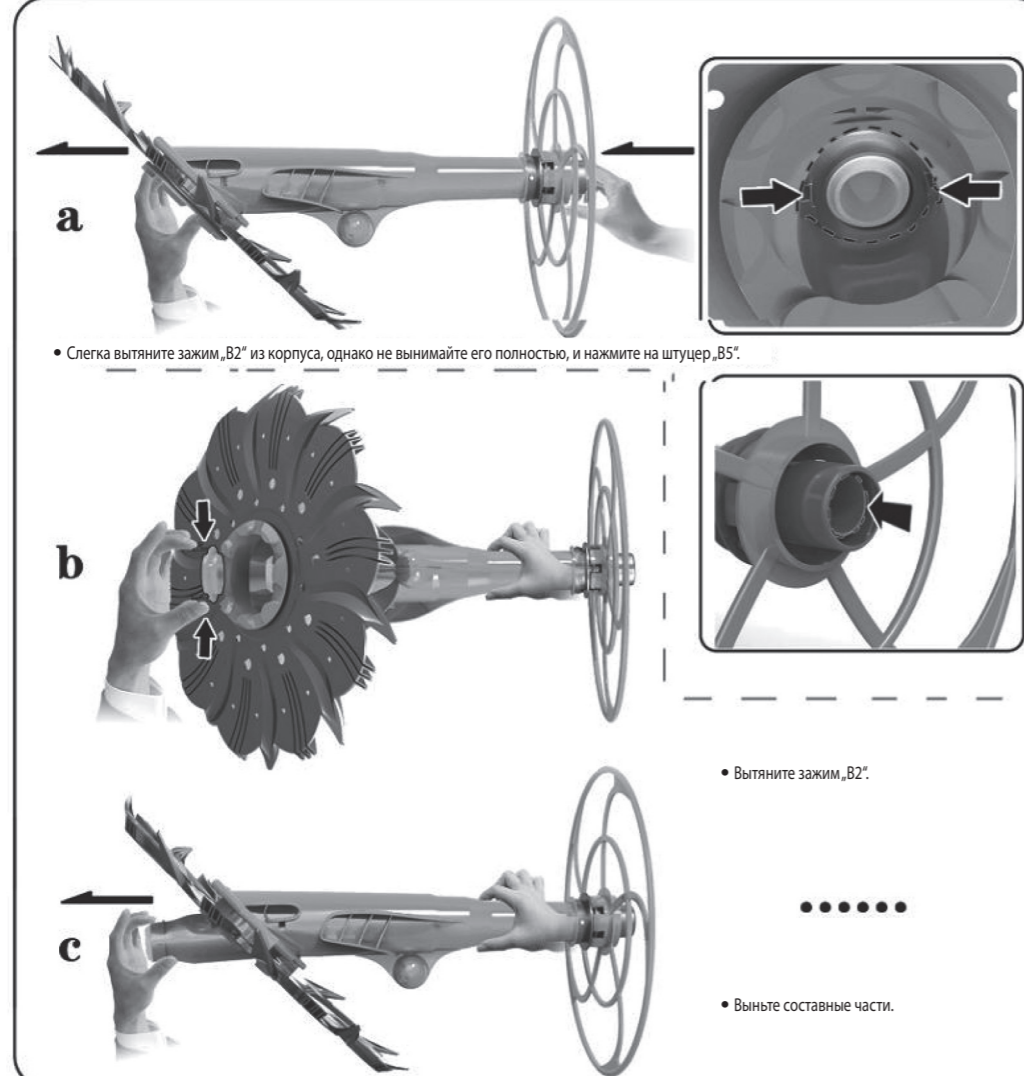
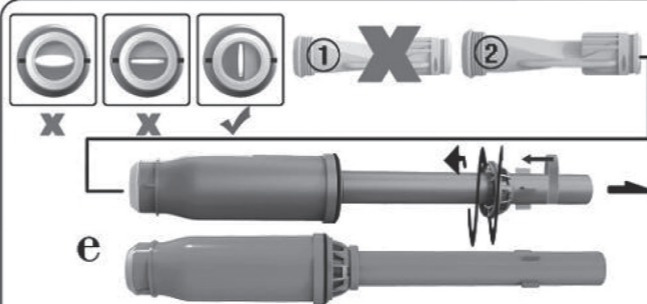
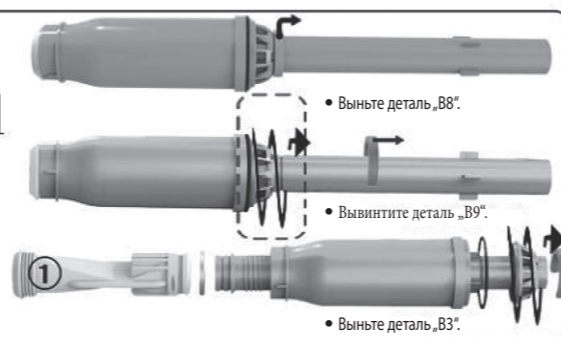
B**d**

ВНИМАНИЕ:
 1) Деталь „B9“ НЕЛЬЗЯ слишком сильно затягивать, иначе мембрана широко откроется, что окажет отрицательное влияние на ее производительность.
 2) Мембрана должна быть расположена на той же линии/направляющей, что и корпус „B6“.

• Установите составные части в очиститель вышеуказанным способом.

• Установите составные части в очиститель вышеуказанным способом.

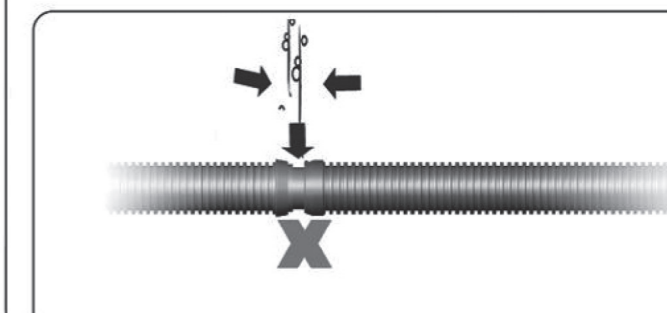
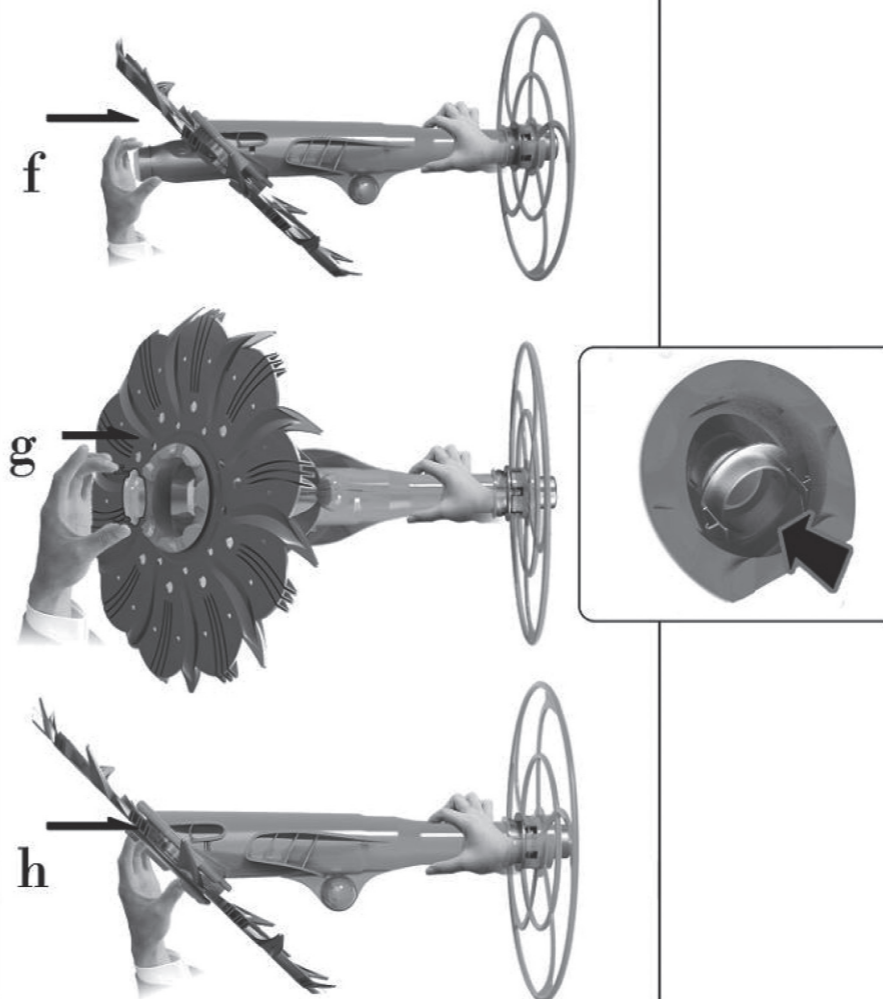

• Места соединения шлангов должны быть полностью герметичными.

Мин. мощность 0,5 лошадиных сил / 1 000 галлонов (3 700 литров)

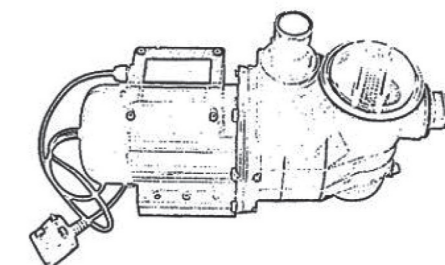

• Насос очистителя должен иметь мощность минимально 0,5 лошадиных сил / 3 700 литров.

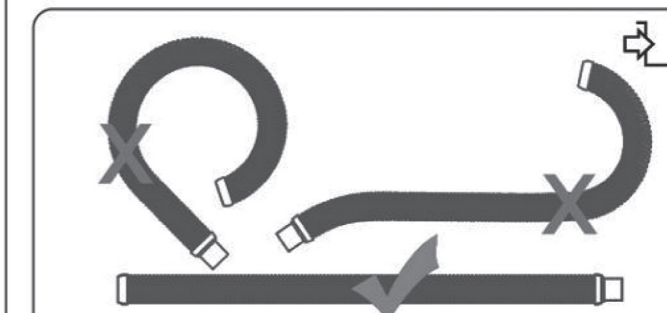

• При хранении шланги всегда укладывайте в расправленном виде